

NUEVA SOLUCIÓN A LAS GRANDES CARGAS Y ESFUERZOS CON LA EXCÉNTRICA DE Ø35 DE ESPIRAL. EVITA POSIBLES AFLOJAMIENTOS POR VIBRACIÓN. PERNOS DE M6, M8 Y DE UNIÓN DOBLE. PARA TABLEROS DE 19 A 34MM DE ESPESOR.

# Excéntrica Ø35 de espiral

# Excéntrica Ø35 de espiral

## EXCÉNTRICAS

|                                  | <i>págs.</i> |
|----------------------------------|--------------|
| <b>1</b> EXCÉNTRICA Y TAPA ..... | 275          |
| <b>2</b> PERNOS .....            | 276          |
| <b>3</b> TUERCAS .....           | 277          |

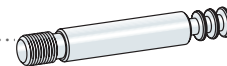

# 1 EXCÉNTRICA Y TAPA

EVITA POSIBLES AFLOJAMIENTOS POR VIBRACIÓN.  
PARA TABLEROS DE 19 EN ADELANTE.

## EXCÉNTRICA Ø35 MM. DE ESPIRAL.

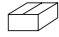
|           |  |             |   |
|-----------|--|-------------|---|
|           |  |             |  |
| NIQUELADO |  | 510.835.065 | 250   |
| ZINCADO   |  | 510.835.032 |   |

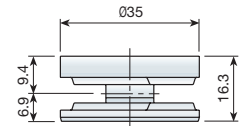
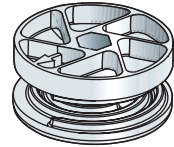
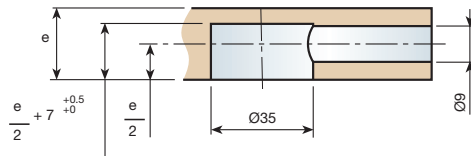

## TAPA EMBELLECEDORA Ø35.

|                 | ESPASOR DE TABLERO | TAPA |             |  |
|-----------------|--------------------|------|-------------|---|
| NIQUELADO       | 19-34              | A    | 531.335.066 |   |
| BLANCO RAL 9003 | >26MM              | B    | 530.500.003 | 1.000   |
| MARRÓN RAL 8016 | >26MM              | B    | 530.500.014 |   |
| NEGRO RAL 9005  | >26MM              | B    | 530.500.025 |   |

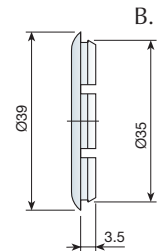
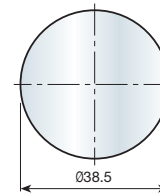
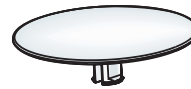

## 2 PERNOS

### PERNO DE UNIÓN.

| DISTANCIA DE TALADRADO = D |         | M6          | M8          |  |
|----------------------------|---------|-------------|-------------|---|
| 35 MM.                     | ZINCADO | 521.735.034 | 521.835.031 | 500   |
| 55 MM.                     | ZINCADO | 521.755.032 | 521.855.036 | 500   |

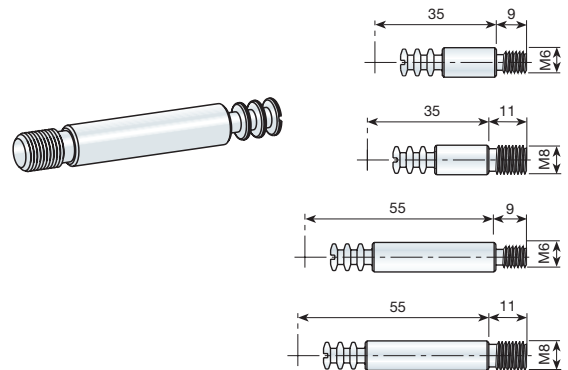
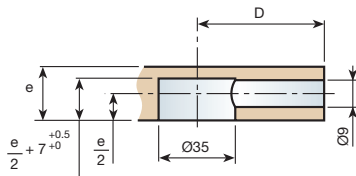

### PERNO DE UNIÓN DOBLE.

|         |             |     |
|---------|-------------|-----|
| ZINCADO | 522.470.034 | 500 |
|---------|-------------|-----|

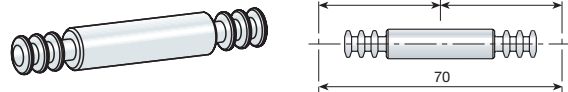
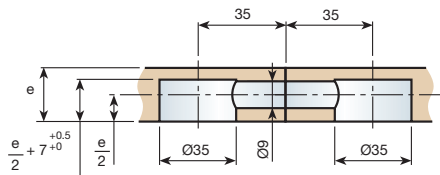

### PERNO DE UNIÓN DOBLE PARA TABLERO INTERMEDIO.

|         |             |     |
|---------|-------------|-----|
| ZINCADO | 522.489.030 | 500 |
|---------|-------------|-----|

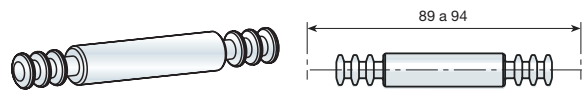
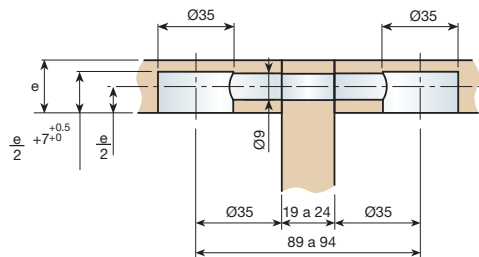

### PERNO DE UNIÓN A ESQUADRA.

|         |             |     |
|---------|-------------|-----|
| ZINCADO | 522.950.035 | 500 |
|---------|-------------|-----|

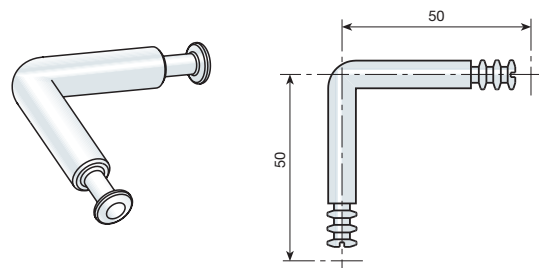
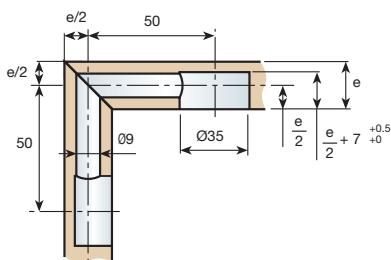

### 3 TUERCAS

#### TUERCA ROSCA MADERA DE ACERO, SIN CABEZA

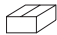
| BICROMATADO |         |          |             |             |   |
|-------------|---------|----------|-------------|-------------|---|
| L (MM.)     | Ød(MM.) | ØD (MM.) | 1/4"        | M6          |  |
| 10          | 8       | 10       | 947.510.056 | 947.810.054 | 2.500   |
| 12          | 8       | 10       | 947.512.053 | 947.812.051 | 2.000   |
| 14          | 8       | 10       | 947.514.050 | 947.814.055 | 2.000   |
| 18          | 8       | 10       | 947.518.051 | 947.818.056 | 2.000   |
| 22          | 8       | 10       | 947.522.052 | 947.822.050 | 2.000   |
| 10          | 9       | 12       | 947.610.053 | 947.910.051 | 2.000   |
| 12          | 9       | 12       | 947.612.050 | 947.912.055 | 2.000   |
| 14          | 9       | 12       | 947.614.054 | 947.914.052 | 2.000   |
| 16          | 9       | 12       | 947.616.051 | 947.616.051 | 2.000   |
| 18          | 9       | 12       | 947.618.055 | 947.918.053 | 2.000   |

| L (MM.) | Ød(MM.) | ØD (MM.) | M8          |  |
|---------|---------|----------|-------------|---|
| 22      | 11      | 14       | 948.222.052 | 1.500   |

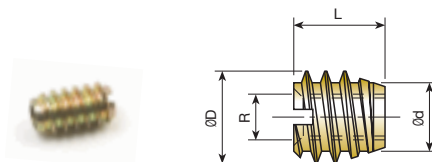

#### TUERCA EXPANSIBLE DE LATÓN

| M4          |  |
|-------------|---|
| 944.805.105 | 2.000 ó 10.000  |

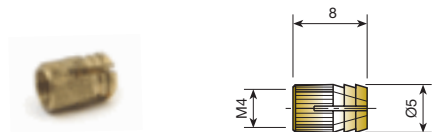

#### TUERCA AUTOEXPANSIBLE DE LATÓN M6

| M6                      |  |
|-------------------------|---|
| 8 Øx 12 MM. 944.112.105 | 5.000   |

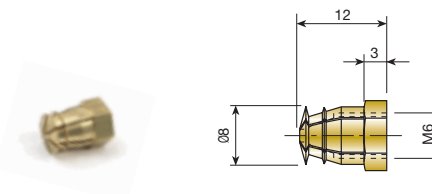

#### TUERCA DE ALETAS

| 1/4"        | M6          |  |
|-------------|-------------|---|
| BICROMATADO | 948.913.055 | 2.000   |
| ZINCADO     | 948.813.036 |   |

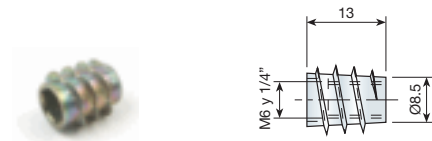

#### TUERCA DE ALETAS CON CABEZA.

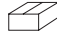
| 1/4"        | M6          | M8          |  |
|-------------|-------------|-------------|---|
| BICROMATADO | 948.713.054 |             | 2.000   |
| ZINCADO     | 948.613.035 | 948.515.035 |   |

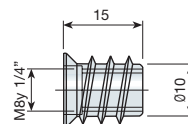
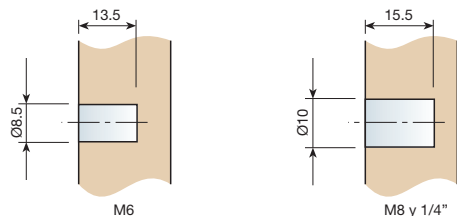

### 3 TUERCAS

#### TUERCA EMPOTRABLE DE NYLON M4 PARA Ø8.

|         |          |             |  |
|---------|----------|-------------|---|
| NATURAL |          | 937.004.106 | 2.000 ó 10.000  |
| MARRÓN  | RAL 8016 | 937.004.014 |   |

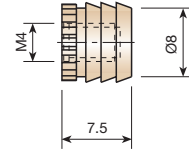

#### TUERCA EMPOTRABLE DE NYLON PARA Ø10

| R       | M6          | 1/4"        |  |
|---------|-------------|-------------|---|
| NATURAL | 937.006.103 | 937.014.105 | 2.000 ó 10.000  |
| MARRÓN  | RAL 8016    | 937.014.013 |   |
| NEGRO   | RAL 9005    | 937.014.024 |   |

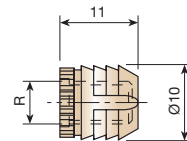

#### TUERCA EMPOTRABLE DE NYLON PARA Ø11

| R       | M6          | 1/4"        |  |
|---------|-------------|-------------|---|
| NATURAL | 937.106.100 | 937.114.102 | 2.000 ó 10.000  |
| MARRÓN  | RAL 8016    | 937.114.010 |   |

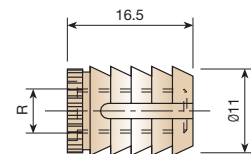

#### TUERCA EMPOTRABLE DE NYLON M6 PARA Ø10, EN TIRAS.

|         |          |             |  |
|---------|----------|-------------|---|
| NATURAL |          | 937.406.105 | 4.800   |
| MARRÓN  | RAL 8016 | 937.406.013 |   |
| NEGRO   | RAL 9005 | 937.014.024 |   |

CADA CAJA CONTIENE 200 TIRAS.  
SE OFRECEN TIRAS DE 24 PIEZAS; SU COLOCACIÓN PUEDE SER MANUAL O POR MEDIO DE PISTOLA NEUMÁTICA CON CARGADOR.

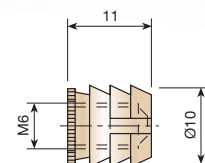

#### TUERCA EMPOTRABLE MOLETEADA DE ACERO M6

| L       | 16 mm.      | 18 mm.      |  |
|---------|-------------|-------------|---|
| ZINCADO | 938.716.100 | 938.718.104 | 1.000 ó 5.000   |

