



SOLUCIÓN A LAS GRANDES CARGAS Y ESFUERZOS PERO CON EL TALADRADO MÍNIMO. LA EXCÉNTRICA DE Ø25 DE ESPIRAL, EVITA POSIBLES AFLOJAMIENTOS POR VIBRACIÓN. PARA TABLEROS DE 15MM DE ESPESOR EN ADELANTE.

Excéntrica Ø25 de espiral

Excéntrica Ø25 de espiral

EXCÉNTRICAS

	<i>págs.</i>
1 EXCÉNTRICA Y TAPA	 267
2 PERNOS	 268
3 TUERCAS	 269
4 MONTAJE	271

1 EXCÉNTRICA Y TAPA

EXCÉNTRICA Ø25 MM DE ESPIRAL.

				
NIQUELADO	511.525.066			500
ZINCADO	511.525.033			

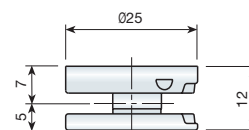
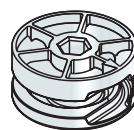

TAPA EMBELLECEDORA Ø25.

		ESPESOR DE TABLERO	TAPA			
NIQUELADO		14 A 20MM	A	530.225.065		1.000
BLANCO	RAL 9003	>20MM	B	530.400.006		
MARRÓN	RAL 8016	>20MM	B	530.400.010		
NEGRO	RAL 9005	>20MM	B	530.400.021		
NIQUELADO		>20MM	B	530.400.065		

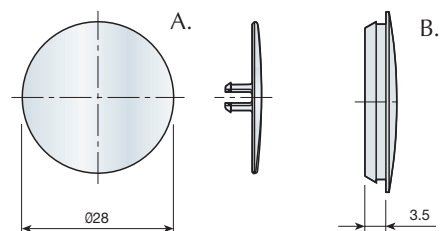

2 PERNOS

PERNO DE UNIÓN.

ZINCADO	520.133.036	500
---------	-------------	-----

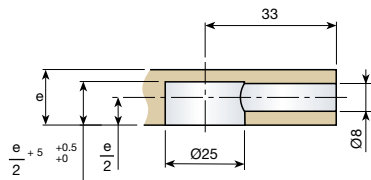
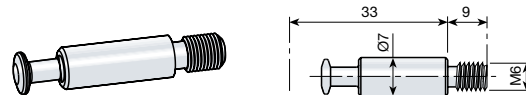

PERNO DE UNIÓN DOBLE.

ZINCADO	528.133.034	500
---------	-------------	-----

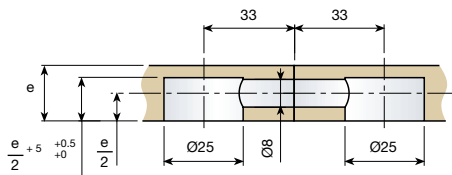
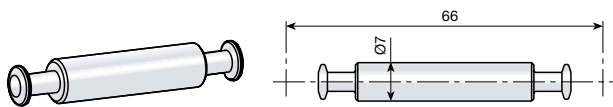

PERNO DE UNIÓN DOBLE PARA TABLERO INTERMEDIO.

ZINCADO	528.233.031	500
---------	-------------	-----

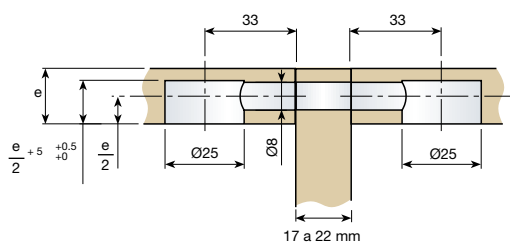
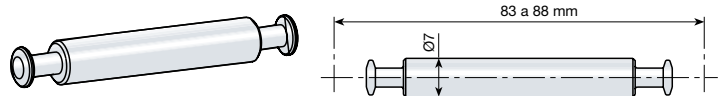

PERNO DE UNIÓN A ESCUADRA.

ZINCADO	528.333.035	500
---------	-------------	-----

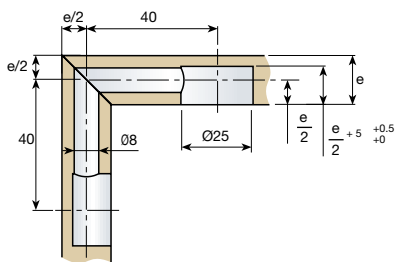
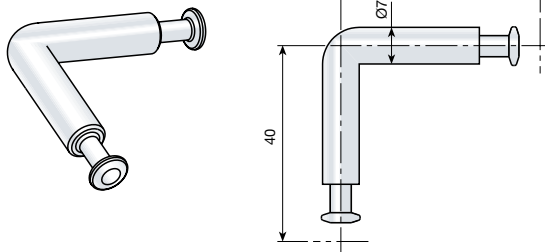

3 TUERCAS

TUERCA ROSCA MADERA DE ACERO, SIN CABEZA

BICROMATADO					
L (MM.)	Ød(MM.)	ØD (MM.)	1/4"	M6	
10	8	10	947.510.056	947.810.054	2.500
12	8	10	947.512.053	947.812.051	2.000
14	8	10	947.514.050	947.814.055	2.000
18	8	10	947.518.051	947.818.056	2.000
22	8	10	947.522.052	947.822.050	2.000
10	9	12	947.610.053	947.910.051	2.000
12	9	12	947.612.050	947.912.055	2.000
14	9	12	947.614.054	947.914.052	2.000
16	9	12	947.616.051	947.616.051	2.000
18	9	12	947.618.055	947.918.053	2.000

L (MM.)	Ød(MM.)	ØD (MM.)	M8	
22	11	14	948.222.052	1.500

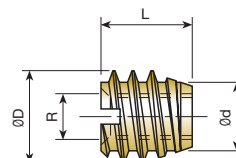

TUERCA EXPANSIBLE DE LATÓN

M4		
944.805.105	2.000 ó 10.000	

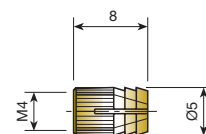

TUERCA AUTOEXPANSIBLE DE LATÓN M6

M6		
8 Øx 12 MM.	944.112.105	5.000

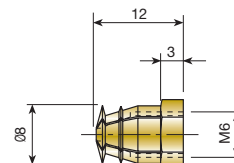

TUERCA DE ALETAS

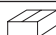
1/4"		M6	
BICROMATADO		948.913.055	2.000
ZINCADO	948.813.036		

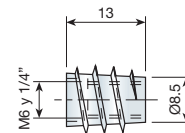

TUERCA DE ALETAS CON CABEZA.

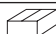
1/4"		M6	M8	
BICROMATADO		948.713.054	2.000	
ZINCADO	948.613.035	948.515.035		

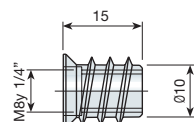
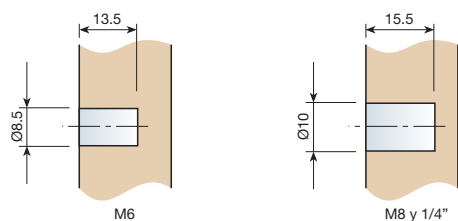
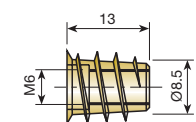

3 TUERCAS

TUERCA EMPOTRABLE DE NYLON M4 PARA Ø8.

			
NATURAL		937.004.106	2.000 ó 10.000
MARRÓN	RAL 8016	937.004.014	

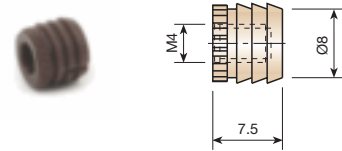

TUERCA EMPOTRABLE DE NYLON PARA Ø10

R	M6	1/4"	
NATURAL	937.006.103	937.014.105	2.000 ó 10.000
MARRÓN	RAL 8016 937.006.011	937.014.013	
NEGRO	RAL 9005 937.006.022	937.014.024	

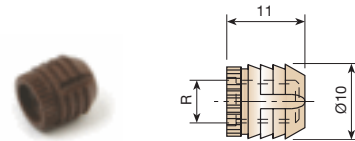

TUERCA EMPOTRABLE DE NYLON PARA Ø11

R	M6	1/4"	
NATURAL	937.106.100	937.114.102	2.000 ó 10.000
MARRÓN	RAL 8016 937.106.015	937.114.010	

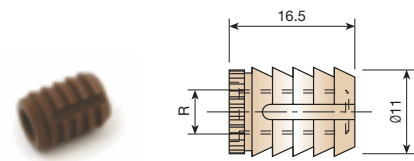

TUERCA EMPOTRABLE DE NYLON M6 PARA Ø10, EN TIRAS.

			
NATURAL		937.406.105	4.800
MARRÓN	RAL 8016	937.406.013	
NEGRO	RAL 9005	937.014.024	

CADA CAJA CONTIENE 200 TIRAS.
SE OFRECEN TIRAS DE 24 PIEZAS; SU COLOCACIÓN PUEDE SER MANUAL O POR MEDIO DE PISTOLA NEUMÁTICA CON CARGADOR.

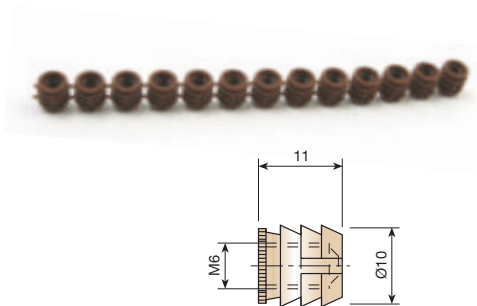

TUERCA EMPOTRABLE MOLETEADA DE ACERO M6

L	16 MM.	18 MM.	
ZINCADO	938.716.100	938.718.104	1.000 ó 5.000

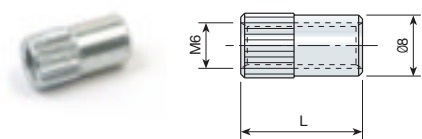

4 MONTAJE

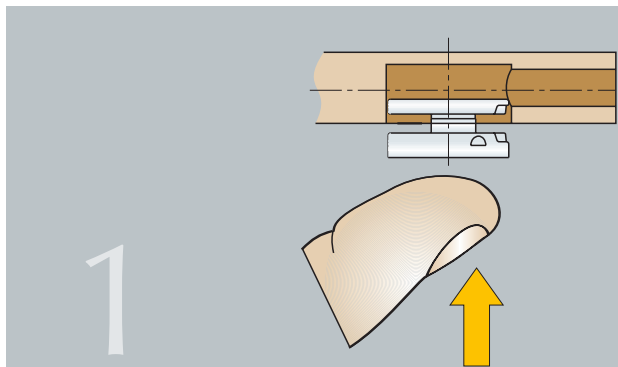

INTRODUCIR MANUALMENTE EL ENSAMBLAJE "EXCÉNTRICA DE ESPIRAL" EN EL MECANIZADO DE LA BALDA O TABLERO.

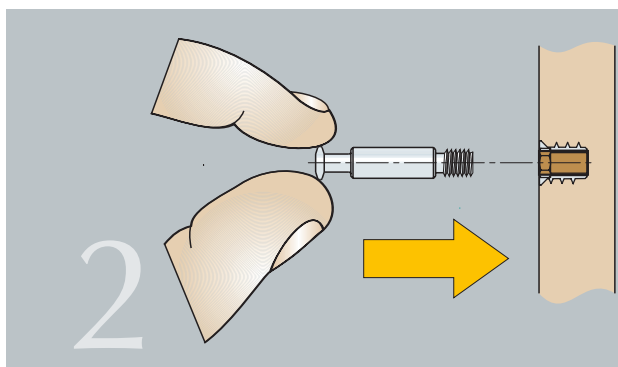

INTRODUCIR LA TUERCA EN EL ALOJAMIENTO DEL COSTADO, Y POSTERIORMENTE ROSCAR EL PERNO A LA TUERCA.

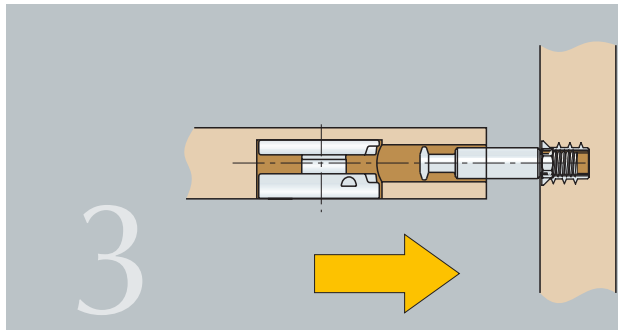

ALINEAR LA "EXCÉNTRICA DE ESPIRAL" CON EL PERNO.

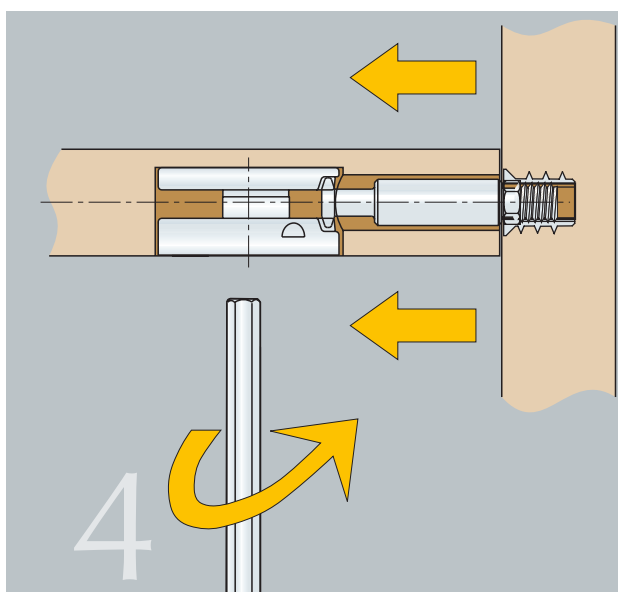

AL EFECTUAR EL GIRO DE LA EXCÉNTRICA, EL PERNO SE DESPLAZA HACIA LA EXCÉNTRICA, Y CONSEGUIMOS UNIR EL LATERAL Y EL ENSAMBLAJE. CON ELLO SE CONSIGUE UN FUERTE Y EFICAZ AMARRE.

PARA DESMONTAR LA BALDA SIGA LOS MISMOS PASOS EN SENTIDO INVERSO.

NOTAS