





ENSAMBLAJE UNIVERSAL DE EXCÉNTRICA Ø15 MM PARA
TODOS NUESTROS MODELOS DE PERNOS, INCLUYENDO
LOS AUTOEXPANDIBLES DE ALTA TOLERANCIA.

Ensamblaje universal excéntrica Ø15

Excéntrica Ø15

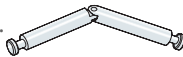
EXCÉNTRICAS

		págs.
1	EXCÉNTRICA Y TAPAS	 245
2	PERNOS	246
■	PERNOS SIMPLES	 246
■	PERNOS ARTICULADOS Y DOBLES	 247
■	PERNOS AUTOEXPANDIBLES	 248
3	TUERCAS	 250

1 EXCÉNTRICA Y TAPAS

TAPA Ø4 MM.

			
BLANCO	RAL 9003	531.217.002	
MARRÓN	RAL 8016	531.217.013	2.000 ó 10.000
NEGRO	RAL 9005	531.217.024	
NIQUELADA (METÁLICA)		531.217.061	

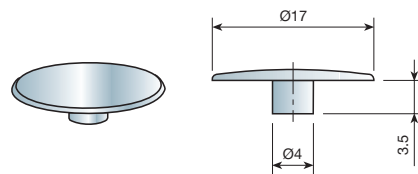

EXCÉNTRICA Ø15 MM.

ESPESOR DE TABLERO DESDE	16 MM.	19 MM.	
C	8 MM.	9,5 MM.	
NATURAL	511.108.102	511.195.101	
ZINCADO NEGRO	511.108.043	511.195.042	2.000
BICROMATADO	511.108.054	511.195.053	
NIQUELADO	511.108.065	511.195.064	

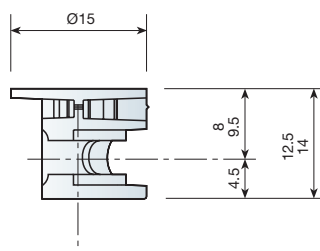
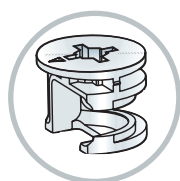
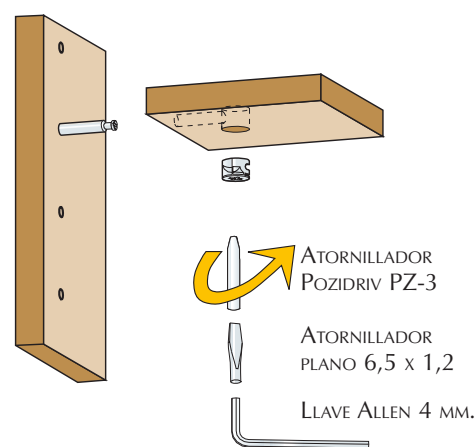

LA MISMA EXCÉNTRICA UNIVERSAL DE Ø15 MM. PUEDE SER UTILIZADA CON TODOS NUESTROS MODELOS DE PERNOS.



PERNO DE ACERO ROSCA MADERA



PERNO DE ZAMAK ROSCA MADERA



PERNO DE ACERO M6



PERNO DE ZAMAK M6



PERNO AUTOEXPANDIBLE DE GRAN TOLERANCIA



PERNO DE DOBLE CUELLO CON ARANDELA DE SEGURIDAD



PERNO DE DOBLE CUELLO

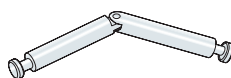

PERNO DE DOBLE CUELLO ARTICULADO

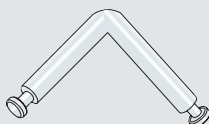

PERNO DE DOBLE CUELLO A ESCUADRA 90°

2 PERNOS

■ PERNOS SIMPLES

PERNO R/MADERA.

	D= 34 MM.	
ACERO ZINCADO	523.834.032	2.500
ZAMAK NATURAL	524.334.101	2.000

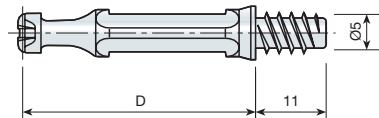
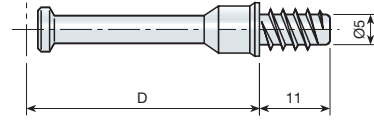
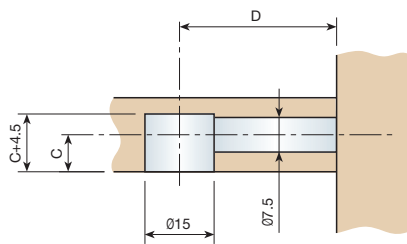

PERNO M6.

	D= 34 MM.	
ACERO ZINCADO	523.934.036	2.500
ZAMAK NATURAL	524.434.105	2.000

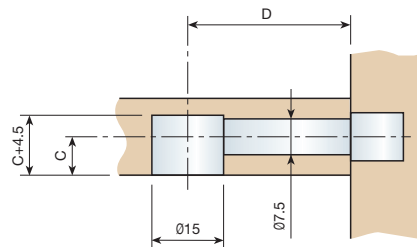
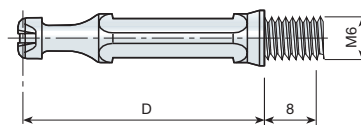
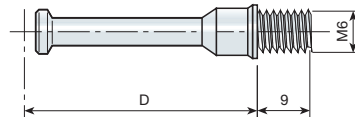
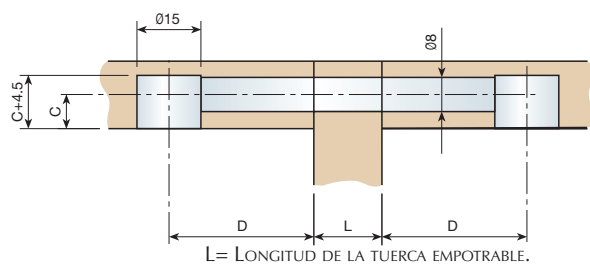

PERNOS ARTICULADOS Y DOBLES

PERNO ARTICULADO.

ZINCADO	524.144.036	1.000
---------	-------------	-------

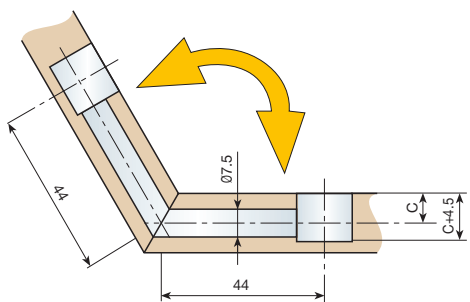
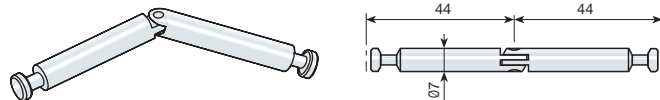

PERNO DOBLE CUELLO A ESCUADRA.

ZINCADO	524.634.036	1.000
	D= 34 MM.	

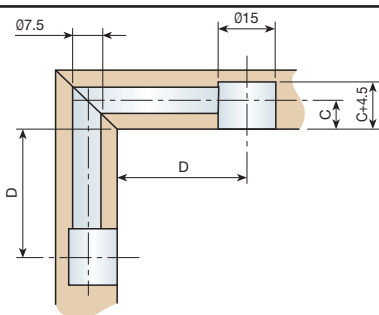
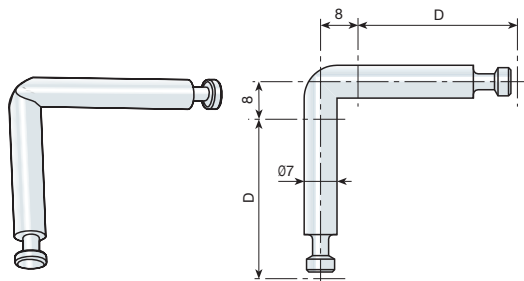

PERNO DOBLE CUELLO.

ZINCADO	524.834.030	1.000
	D= 34 MM.	

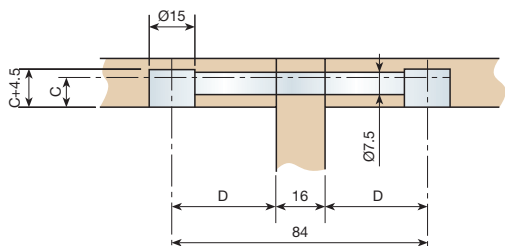
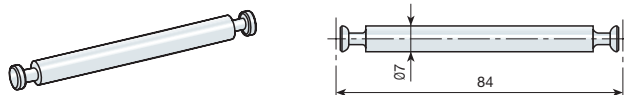

PERNO DOBLE CUELLO CON ARANDELA.

ZINCADO	524.724.034	1.000
D= 24 MM	524.724.034	
D= 34 MM	524.734.033	

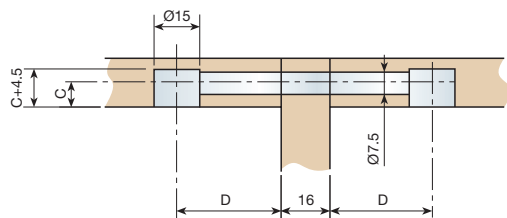
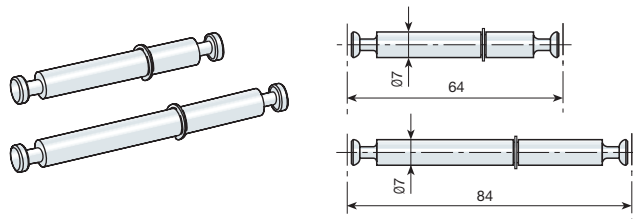

■ **PERNOS AUTOEXPANDIBLES**

LA INCORPORACIÓN DE ESTE PERNO IMPLICA UNA MEJORA SENSIBLE EN LA RAPIDEZ DE MONTAJE, TANTO A ESCALA INDUSTRIAL COMO EN SISTEMA "KIT".

DISPONIBLES PARA CENTRO DE TALADRADO DE 24 O 34 MM. AMBOS IGUALMENTE PARA TALADRADO DEL COSTADO DE 5, 8 O 10MM. DE DIÁMETRO.

PERNO AUTOEXPANDIBLE.

NATURAL	Ø5 MM.	Ø8 MM.	Ø10 MM.	
D= 24 MM.	525.224.103	525.324.100	525.424.104	2.000
D= 34 MM.	525.234.102	525.334.106	525.434.103	

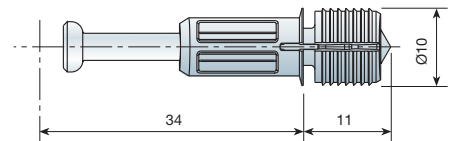
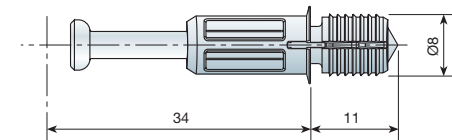
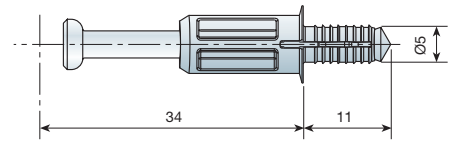
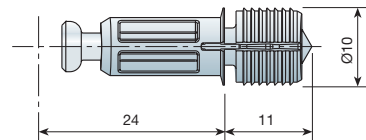
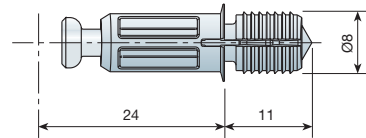
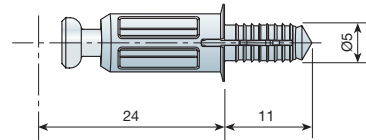

PUEDE SER COLOCADO O RETIRADO DE SU ALOJAMIENTO MANUALMENTE.
NO SE PRECISA DE NINGUNA HERRAMIENTA COMPLEMENTARIA.

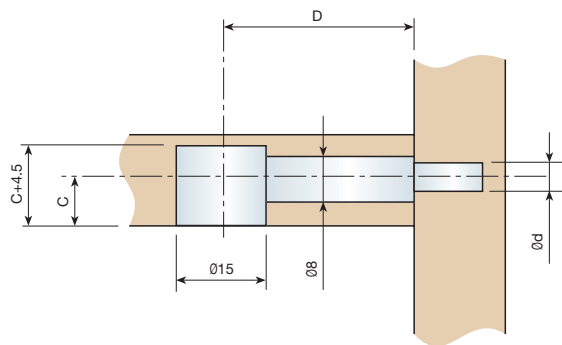

Montaje

AL EFECTUARSE EL GIRO DE LA EXCÉNTRICA EL VÁSTAGO SE DESPLAZA, EXPANDIÉNDOSE SIMULTÁNEAMENTE LA PARTE QUE PERMANECE ALOJADA EN EL COSTADO. CON ELLO SE CONSIGUE UN FUERTE Y EFICAZ ENCLAVAMIENTO.

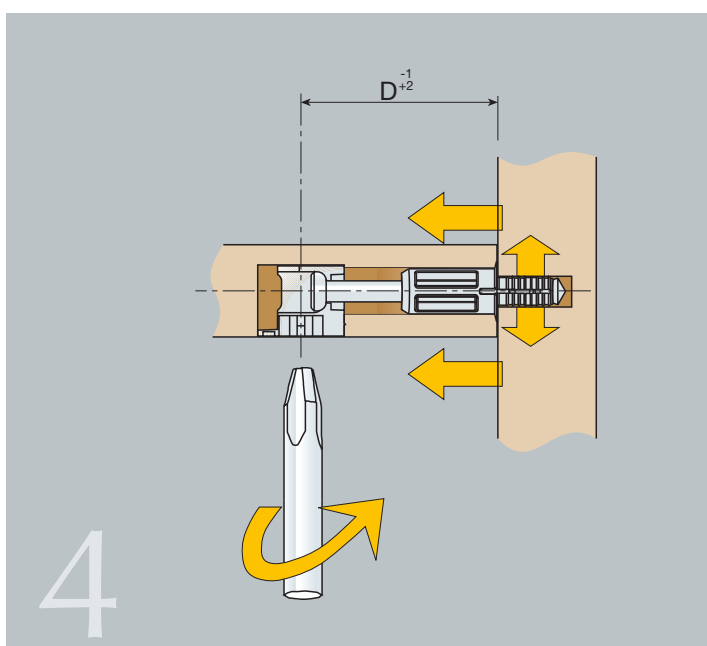
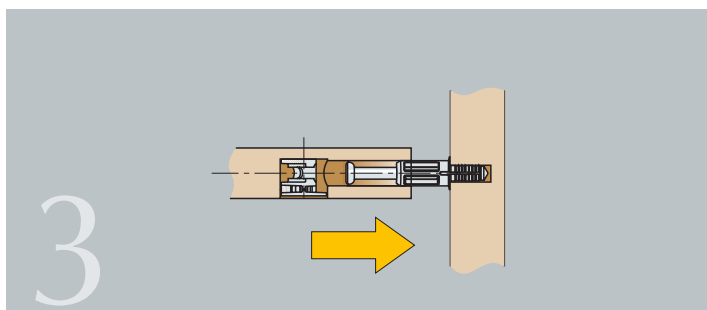
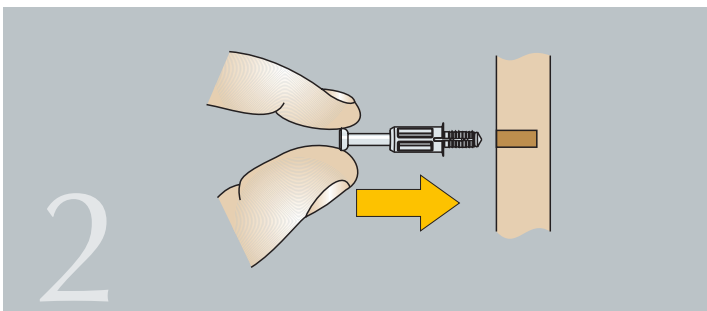
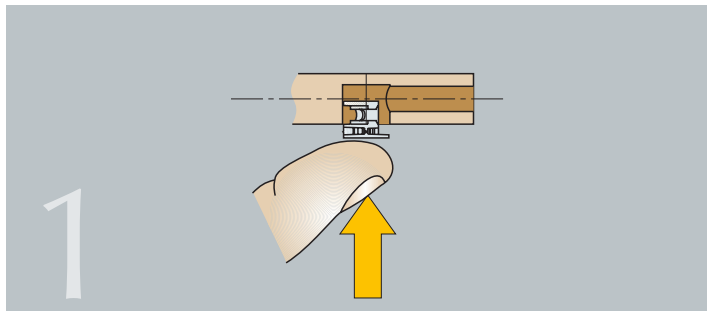

5 TUERCAS

TUERCA ROSCA MADERA DE ACERO, SIN CABEZA

BICROMATADO					
L (MM.)	Ød(MM.)	ØD (MM.)	1/4"	M6	
10	8	10	947.510.056	947.810.054	2.500
12	8	10	947.512.053	947.812.051	2.000
14	8	10	947.514.050	947.814.055	2.000
18	8	10	947.518.051	947.818.056	2.000
22	8	10	947.522.052	947.822.050	2.000
10	9	12	947.610.053	947.910.051	2.000
12	9	12	947.612.050	947.912.055	2.000
14	9	12	947.614.054	947.914.052	2.000
16	9	12	947.616.051	947.616.051	2.000
18	9	12	947.618.055	947.918.053	2.000

L (MM.)	Ød(MM.)	ØD (MM.)	M8	
22	11	14	948.222.052	1.500

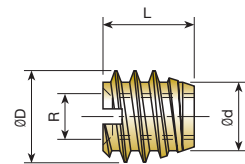

TUERCA EXPANSIBLE DE LATÓN

M4			
944.805.105	2.000 ó 10.000		

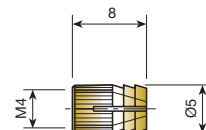

TUERCA AUTOEXPANSIBLE DE LATÓN M6

M6			
8 Øx 12 MM.	944.112.105	5.000	

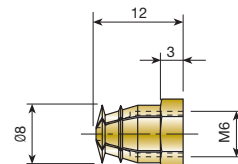

TUERCA DE ALETAS

1/4"		M6	
BICROMATADO	948.913.055	2.000	
ZINCADO	948.813.036		

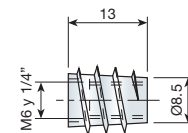

TUERCA DE ALETAS CON CABEZA.

1/4"		M6	M8	
BICROMATADO	948.713.054	2.000		
ZINCADO	948.613.035		948.515.035	

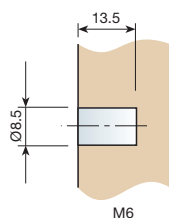
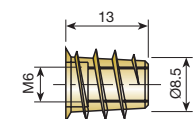

M6

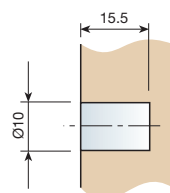

M8 y 1/4"

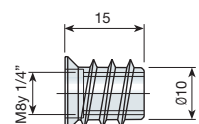

TUERCA EMPOTRABLE DE NYLON M4 PARA Ø8.

			
NATURAL		937.004.106	2.000 ó 10.000
MARRÓN	RAL 8016	937.004.014	

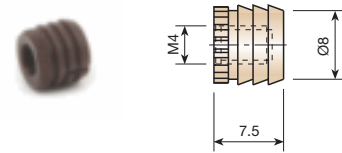

TUERCA EMPOTRABLE DE NYLON PARA Ø10

R	M6	1/4"	
NATURAL	937.006.103	937.014.105	2.000 ó 10.000
MARRÓN	RAL 8016 937.006.011	937.014.013	
NEGRO	RAL 9005 937.006.022	937.014.024	

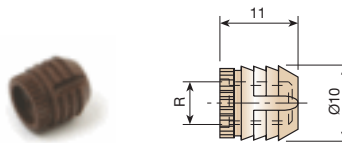

TUERCA EMPOTRABLE DE NYLON PARA Ø11

R	M6	1/4"	
NATURAL	937.106.100	937.114.102	2.000 ó 10.000
MARRÓN	RAL 8016 937.106.015	937.114.010	

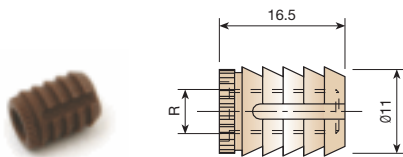

TUERCA EMPOTRABLE DE NYLON M6 PARA Ø10, EN TIRAS.

			
NATURAL		937.406.105	4.800
MARRÓN	RAL 8016	937.406.013	
NEGRO	RAL 9005	937.014.024	

CADA CAJA CONTIENE 200 TIRAS.
SE OFRECEN TIRAS DE 24 PIEZAS; SU COLOCACIÓN PUEDE SER MANUAL O POR MEDIO DE PISTOLA NEUMÁTICA CON CARGADOR.

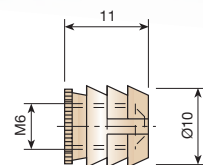

TUERCA EMPOTRABLE MOLETEADA DE ACERO M6

L	16 MM.	18 MM.	
ZINCADO	938.716.100	938.718.104	1.000 ó 5.000

