

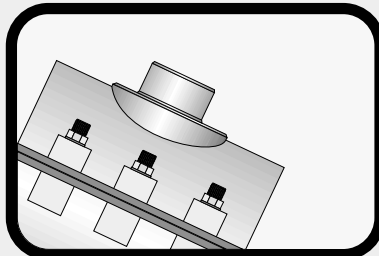

CAUDAL®

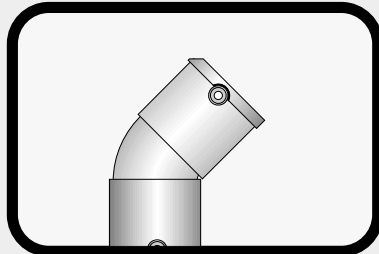
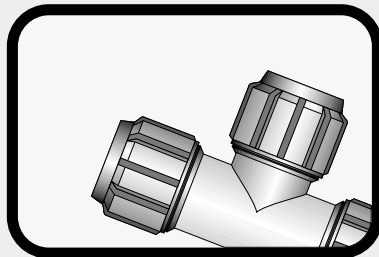

Accesorios para polietileno
Fittings for PE pipes
Accessoires pour tuyaux en PE

2003

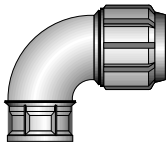

Medida	20 -1/2"	25 -3/4"	32 -1"	40 -1 1/4"	50 -1 1/2"	63 -2"	75 -2 1/2"	90 -3"	110 - 4"
Código	3CDRH20	3CDRH25	3CDRH32	3CDRH40	3CDRH50	3CDRH63	3CDRH75	3CDRH90	3CDRH110
U/Caja	250	150	100	70	50	25	12	7	4
P.N.	10	10	10	10	10	10	6	6	6

Codo 90° hembra

Elbows, 90° female thread
Coude 90°, filetage femelle

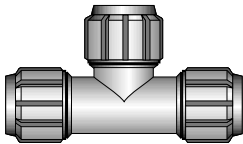

Medida	20	25	32	40	50	63	75	90	110
Código	3T20	3T25	3T32	3T40	3T50	3T63	3T75	3T90	3T110
U/Caja	100	75	45	30	20	11	5	2	1
P.N.	10	10	10	10	10	10	6	6	6

TE igual

Tee
Te bouches égales

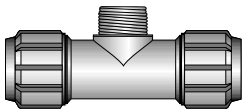

Medida	20-1/2"	25-3/4"	32-1"	40-1 1/4"	50-1 1/2"	63-2"
Código	3TRM20	3TRM25	3TRM32	3TRM40	3TRM50	3TRM63
U/Caja	150	100	60	35	25	16
P.N.	10	10	10	10	10	10

TE derivación macho

Tee, male thread
Te filegate mâle

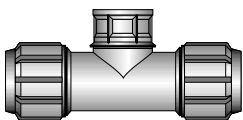

Medida	20-1/2"	25-3/4"	32-1"	40-1 1/4"	50-1 1/2"	63-2"	75-2 1/2"	90-3"	110-4"
Código	3TRH20	3TRH25	3TRH32	3TRH40	3TRH50	3TRH63	3TRH75	3TRH90	3TRH110
U/Caja	125	75	45	35	25	15	8	4	2
P.N.	10	10	10	10	10	10	6	6	6

TE derivación hembra

Tee, female thread
Te filegate femelle

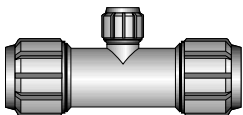

Medida	25-20	32-25	40-32	50-40	63-50	75-63
Código	3TRD25	3TRD32	3TRD40	3TRD50	3TRD63	3TRD75
U/Caja	75	45	20	12	8	8
P.N.	10	10	10	10	10	10

TE 90° reducida

Reducer tee
Te réduit

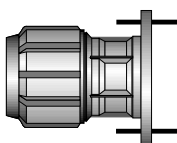

Medida		50	63	75	90	110
Código		3ELB50	3ELB63	3ELB75	3ELB90	3ELB110
U/Caja		16	12	8	5	4
P.N.		10	10	6	6	6

Enlace brida

Flanged joint
Joint à bride

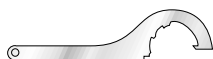

Medida	25-32	40-75	63-110
Código	3LL2532	3LL4075	3LL63110
Acabado	Zincada	Zincada	Zincada
U/Caja	1	1	1

Llave gancho FITTING metálica zincada

Key to fitting hook
Clef crochet fitting

Dimensiones:
Dimensions:
Dimensiones:

Todos nuestros accesorios son aptos para uso de agua potable
All our accessories are used for drinkable water
Notres accessoires sont utilisés pour l'eau potable

Stándar para tuberías de Polietileno fabricadas con dimensiones según normas:
Standard for PE pipes made with dimensions as rules:
Standar pour tuyaux fabrique selon les normes:

UNE 53131 , UNE 53367 y UNE 53966Ex

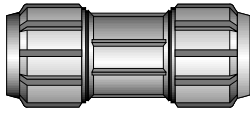

Medida	20	25	32	40	50	63	75	90	110
Código	3MNUN20	3MNUN25	3MNUN32	3MNUN40	3MNUN50	3MNUN63	3MNUN75	3MNUN90	3MNUN110
U/Caja	175	125	75	45	35	20	12	5	3
P.N.	12,5	12,5	12,5	10	10	10	6	6	6

Manguito

Straight coupling
Union droit

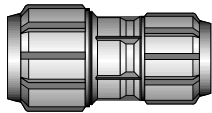

Medida	25-20	32-25	40-32	50-40	63-50	75-63	90-75	110-90
Código	3MNRD25	3MNRD32	3MNRD40	3MNRD50	3MNRD63	3MNRD75	3MNRD90	3MNRD110
U/Caja	150	100	60	40	25	12	6	4
P.N.	12,5	12,5	10	10	10	10	6	6

Manguito reducido

Reducing coupling
Union droit réduite

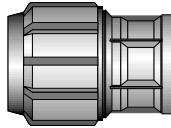

Medida	20-1/2"	25-3/4"	32-1"	40-1 1/4"	50-1 1/2"	63-2"	75-2 1/2"	90-3"	110-4"
Código	3TMRH20	3TMRH25	3TMRH32	3TMRH40	3TMRH50	3TMRH63	3TMRH75	3TMRH90	3TMRH110
U/Caja	350	200	150	100	70	35	18	10	6
P.N.	12,5	12,5	12,5	10	10	10	6	6	6

Enlace rosca hembra

Coupling, female thread
Union droite mixte-femelle

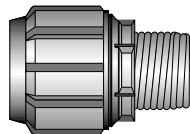

Medida	20-1/2"	25-3/4"	32-1"	40-1 1/4"	50-1 1/2"	63-2"	75-2 1/2"	90-3"	110-4"
Código	3TMRM20	3TMRM25	3TMRM32	3TMRM40	3TMRM50	3TMRM63	3TMRM75	3TMRM90	3TMRM110
U/Caja	400	225	150	100	75	35	18	10	7
P.N.	12,5	12,5	12,5	10	10	10	6	6	6

Enlace rosca macho

Coupling, male thread
Union droite mixte-mâle

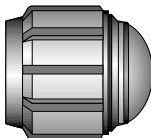

Medida	20	25	32	40	50	63	75	90	110
Código	3TP20	3TP25	3TP32	3TP40	3TP50	3TP63	3TP75	3TP90	3TP110
U/Caja	400	250	200	110	75	40	18	10	7
P.N.	12,5	12,5	12,5	10	10	10	6	6	6

Tapón

Cap
Bouchon final

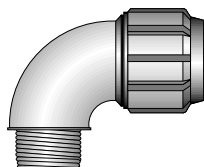

Medida	20-1/2"	25-3/4"	32-1"	40-1 1/4"	50-1 1/2"	63-2"
Código	3CDRM20	3CDRM25	3CDRM32	3CDRM40	3CDRM50	3CDRM63
U/Caja	250	200	100	65	50	25
P.N.	12,5	12,5	12,5	10	10	10

Codo 90° macho

Elbows 90°, male thread
Coude 90°, filegate mâle

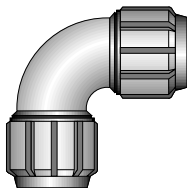

Medida	20	25	32	40	50	63	75	90	110
Código	3CD20	3CD25	3CD32	3CD40	3CD50	3CD63	3CD75	3CD90	3CD110
U/Caja	150	125	75	45	30	15	8	4	2
P.N.	12,5	12,5	12,5	10	10	10	6	6	6

Codo 90° igual

Elbows 90°
Coude 90° bouches égales



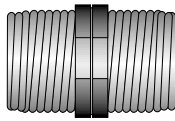

Medida	20	25	32	40	50	63	75	90
Código	5MA20	5MA25	5MA32	5MA40	5MA50	5MA63	5MA75	5MA90
U/Caja	250	150	50	50	45	20	10	5
P.N.	10	10	10	10	10	10	10	10

Machón

Nipple
Mamelons doubles

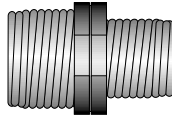

Medida	25-20	32-25	40-32	50-40	63-50	75-63
Código	5MARD25	5MARD32	5MARD40	5MARD50	5MARD63	5MARD75
U/Caja	150	100	50	50	20	10
P.N.	10	10	10	10	10	10

Machón reducido

Male-male reducer nipple
Mamelons doubles réduits doubles

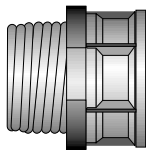

Medida	25-20	32-25	40-32	50-40	63-50	75-63
Código	5TURD25	5TURD32	5TURD40	5TURD50	5TURD63	5TURD75
U/Caja	150	150	50	50	30	15
P.N.	10	10	10	10	10	10

Reducción macho-hembra

Male-female reducer nipple
Réductions m-f

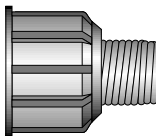

Medida	25-20	32-25	40-32	50-40	63-50	75-63
Código	5TURDHM25	5TURDHM32	5TURDHM40	5TURDHM50	5TURDHM63	5TURDHM75
U/Caja	150	100	75	40	25	12
P.N.	10	10	10	10	10	10

Reducción hembra-macho

Female-male reducer nipple
Reduction taraude



Medida	20	25	32	40	50	63	75
Código	5TPRM20	5TPRM25	5TPRM32	5TPRM40	5TPRM50	5TPRM63	5TPRM75
U/Caja	350	250	100	50	50	25	15
P.N.	10	10	10	10	10	10	10

Tapón rosca macho

Male plug
Bouchon male

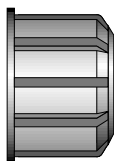

Medida	20	25	32	40	50	63	75
Código	5TPRH20	5TPRH25	5TPRH32	5TPRH40	5TPRH50	5TPRH63	5TPRH75
U/Caja	350	250	50	50	50	25	15
P.N.	10	10	10	10	10	10	10

Tapón rosca hembra

Blanking cap
Bouchon female

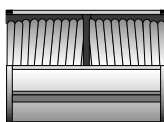

Medida	20	25
Código	5MNUN20	5MNUN25
U/Caja	150	100
P.N.	10	10

Manguito rosca hembra

Treaded coupling
Manchon taraude

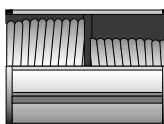

Medida	20-25
Código	5MNRD25
U/Caja	100
P.N.	10

Manguito rosca hembra reducido

Female-female reducer nipple
Manchon réduit taraude

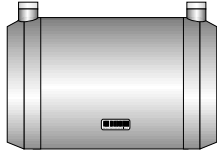

Medida	20	25	32	40	50	63	75	90	110	125
Código	3MNUNE20	3MNUNE25	3MNUNE32	3MNUNE40	3MNUNE50	3MNUNE63	3MNUNE75	3MNUNE90	3MNUNE110	3MNUNE125
U/Caja	50	40	30	20	12	15	8	8	4	6
P.N.	16	16	16	16	16	16	16	16	16	16

Medida	140	160	180	200	225	250	280	315	355	450
Código	3MNUNE140	3MNUNE160	3MNUNE180	3MNUNE200	3MNUNE225	3MNUNE250	3MNUNE280	3MNUNE315	3MNUNE355	3MNUNE450
U/Caja	4	4	1	1	2	1	1	1	1	1
P.N.	16	16	16	16	16	16	16	16	16	16

Manguito unión electrosoldable sin tope

Slide ocer coupler electrofusion
Manchon electrosoldable sans butée

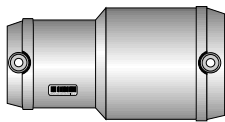

Medida	25-20	32-25	40-32	50-40	63-50	75-63	90-75	110-90	125-90	160-110
Código	3MNRDE25	3MNRDE32	3MNRDE40	3MNRDE50	3MNRDE63	3MNRDE75	3MNRDE90	3MNRDE110	3MNRDE12590	3MNRDE160110
U/Caja	40	25	50	10	14	12	10	12	6	1
P.N.	16	16	16	16	16	16	16	16	16	16

Manguito reducido electrosoldable

Reducer electrofusion
Manchon electrosoldable réduit

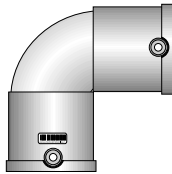

Medida	20	25	32	40	50	63	75	90	110	125	160	180
Código	3CDE20	3CDE25	3CDE32	3CDE40	3CDE50	3CDE63	3CDE75	3CDE90	3CDE110	3CDE125	3CDE160	3CDE180
U/Caja	30	25	20	12	15	10	5	6	4	3	5	1
P.N.	16	16	16	16	16	16	16	16	16	16	16	16

Codo 90° electrosoldable

Elbow 90° electrofusion
Coude 90° electrosoldable

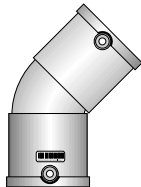

Medida	20	25	32	40	50	63	75	90	110	125	160	180
Código	3CDE4520	3CDE4525	3CDE4532	3CDE4540	3CDE4550	3CDE4563	3CDE4575	3CDE4590	3CDE45110	3CDE45125	3CDE45160	3CDE45180
U/Caja	40	30	20	14	18	12	10	9	6	4	2	1
P.N.	16	16	16	16	16	16	16	16	16	16	16	16

Codo 45° electrosoldable

Elbow 45° electrofusion
Coude 45° electrosoldable

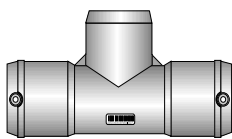

Medida	20	25	32	40	50	63	75	90	110	125	160	180
Código	3TE20	3TE25	3TE32	3TE40	3TE50	3TE63	3TE75	3TE90	3TE110	3TE125	3TE160	3TE180
U/Caja	10	16	25	20	12	12	8	5	3	3	1	1
P.N.	16	16	16	16	16	16	16	16	16	16	16	16

Te 90° electrosoldable

Tee-pieces electrofusion
Té electrosoldable

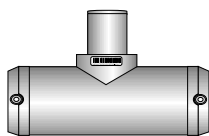

Medida	63-32	90-63	110-63	110-90	160-90	160-110	160-125
Código	3TRDE6332	3TRDE9063	3TRDE11063	3TRDE11090	3TRDE16090	3TRDE160110	3TRDE160125
U/Caja	1	4	1	1	1	1	1
P.N.	16	16	16	16	16	16	16

Te 90° reducida electrosoldable

Reducer tee-pieces electrofusion
Te electrosoldable réduit

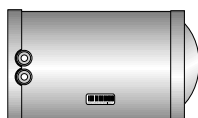

Medida	20	25	32	40	50	63	75	90	110	125	140	160
Código	3TPE20	3TPE25	3TPE32	3TPE40	3TPE50	3TPE63	3TPE75	3TPE90	3TPE110	3TPE125	3TPE140	3TPE160
U/Caja	60	40	25	20	12	20	10	1	4	6	1	1
P.N.	16	16	16	16	16	16	16	16	16	16	16	16

Tapón final electrosoldable

End cap electrofusion
Bouchon electrosoldable

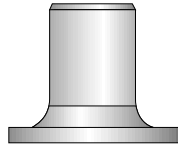

Medida	20	25	32	40	50	63	75	90	110
Código	3MNBTD20	3MNBTD25	3MNBTD32	3MNBTD40	3MNBTD50	3MNBTD63	3MNBTD75	3MNBTD90	3MNBTD110
U/Caja	50	40	24	15	25	12	10	6	4
P.N.	16	16	16	16	16	16	16	16	16

Medida	125	140	160	180	200	225	250	280	315
Código	3MNBTD125	3MNBTD140	3MNBTD160	3MNBTD180	3MNBTD200	3MNBTD225	3MNBTD250	3MNBTD280	3MNBTD315
U/Caja	3	4	4	4	1	1	2	1	2
P.N.	16	16	16	16	16	16	16	16	16

Manguito portabridas soldadura tope

Flange adaptor butt welding
Collet soudable bout à bout

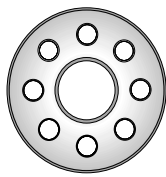

Medida	20	25	32	40	50	63	75	90	110
Código	3BRT20	3BRT25	3BRT32	3BRT40	3BRT50	3BRT63	3BRT75	3BRT90	3BRT110
U/Caja	1	1	1	1	1	1	1	1	1
P.N.	16	16	16	16	16	16	16	16	16

Medida	125	140	160	180	200	225	250	280	315
Código	3BRT125	3BRT140	3BRT160	3BRT180	3BRT200	3BRT225	3BRT250	3BRT280	3BRT315
U/Caja	1	1	1	1	1	1	1	1	1
P.N.	16	16	16	16	16	16	16	16	16

Brida soldadura tope

Plain flange butt welding
Bride soudable bout à bout

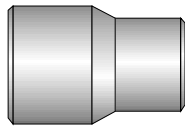

Medida	25-20	32-25	40-32	50-40	63-50	75-63	90-75	110-90	125-110
Código	3MNRDT25	3MNRDT32	3MNRDT40	3MNRDT50	3MNRDT63	3MNRDT75	3MNRDT90	3MNRDT110	3MNRDT125
U/Caja	80	50	30	40	25	15	12	8	4
P.N.	16	16	16	16	16	16	16	16	16

Medida	140-125	160-140	180-160	200-160	225-160	250-200
Código	3MNRDT140	3MNRDT160	3MNRDT180	3MNRDT200	3MNRDT225	3MNRDT250
U/Caja	6	1	1	1	1	1
P.N.	16	16	16	16	16	16

Reducción soldadura tope

Reduction butt welding
Manchon réduit soudable bout à bout

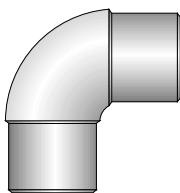

Medida	20	25	32	40	50	63	75	90	110
Código	3CDT20	3CDT25	3CDT32	3CDT40	3CDT50	3CDT63	3CDT75	3CDT90	3CDT110
U/Caja	60	40	30	15	10	6	10	6	3
P.N.	16	16	16	16	16	16	16	16	16

Medida	125	140	160	180	200	225	250	280	315
Código	3CDT125	3CDT140	3CDT160	3CDT180	3CDT200	3CDT225	3CDT250	3CDT280	3CDT315
U/Caja	2	2	3	2	1	1	2	2	1
P.N.	16	16	16	16	16	16	16	16	16

Codo 90° soldadura tope

Elbow 90° butt welding
Coude 90° soudable bout à bout

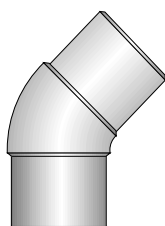

Medida	20	25	32	40	50	63	75	90	110
Código	3CDT4520	3CDT4525	3CDT4532	3CDT4540	3CDT4550	3CDT4563	3CDT4575	3CDT4590	3CDT45110
U/Caja	100	70	35	25	15	8	12	6	4
P.N.	16	16	16	16	16	16	16	16	16

Medida	125	140	160	180	200	225	250	280	315
Código	3CDT45125	3CDT45140	3CDT45160	3CDT45180	3CDT45200	3CDT45225	3CDT45250	3CDT45280	3CDT45315
U/Caja	3	2	2	2	2	1	3	3	1
P.N.	16	16	16	16	16	16	16	16	16

Codo 45° soldadura tope

Elbow 45° butt welding
Coude 45° soudable bout à bout

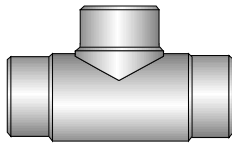

Medida	20	25	32	40	50	63	75	90	110
Código	3TT20	3TT25	3TT32	3TT40	3TT50	3TT63	3TT75	3TT90	3TT110
U/Caja	40	30	15	12	8	8	5	10	5
P.N.	16	16	16	16	16	16	16	16	16

Medida	125	140	160	180	200	225	250	280	315
Código	3TT125	3TT140	3TT160	3TT180	3TT200	3TT225	3TT250	3TT280	3TT315
U/Caja	3	3	2	1	1	1	1	1	1
P.N.	16	16	16	16	16	16	16	16	16

Te 90° soldadura tope

Tee 90° butt welding
Te 90° soudable bout à bout

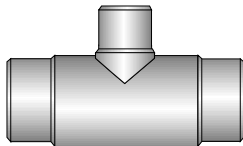

Medida	63-50	75-63	90-75	110-90	125-110	160-63	160-75	160-90	160-110
Código	3TRDT6350	3TRDT7563	3TRDT9075	3TRDT11090	3TRDT125110	3TRDT16063	3TRDT16075	3TRDT16090	3TRDT160110
U/Caja	24	12	10	10	8	3	3	3	3
P.N.	16	16	16	16	16	16	16	16	16

Medida	180-90	180-110	180-160	200-110	200-160	225-90	225-110	225-160	225-180
Código	3TRDT18090	3TRDT180110	3TRDT180160	3TRDT200110	3TRDT200160	3TRDT22590	3TRDT225110	3TRDT225160	3TRDT225180
U/Caja	2	2	2	1	1	1	1	1	1
P.N.	16	16	16	16	16	16	16	16	16

Te 90° reducida soldadura tope

Reducer tee 90° butt welding
Te 90° réduit soudable bout à bout

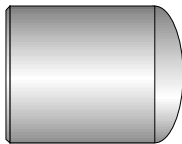

Medida	20	25	32	40	50	63	75	90	110
Código	3TPT20	3TPT25	3TPT32	3TPT40	3TPT50	3TPT63	3TPT75	3TPT90	3TPT110
U/Caja	200	100	80	50	35	20	25	16	10
P.N.	16	16	16	16	16	16	16	16	16

Medida	125	140	160	180	200	225	250	280	315
Código	3TPT125	3TPT140	3TPT160	3TPT180	3TPT200	3TPT225	3TPT250	3TPT280	3TPT315
U/Caja	8	15	9	2	2	1	1	2	1
P.N.	16	16	16	16	16	16	16	16	16

Tapón soldadura tope

Cap butt welding
Bouchon soudable bout à bout

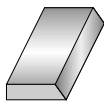

Denominación	HOJAS DE REPUESTO
Código	3HRM
U/Caja	4
Material	Acero

Hojas de repuesto rascador manual

Scraper
Frottoir



Cortes	4
Código	3RM
U/Caja	1
Material	Plastico

Rascador manual

Hand scraper
Frottoir manuel

NOVEDAD



Aplicación	Universal	Universal
Código	3MQE	3MQE25
U/Caja	1	1
Lapiz optico	No	Si

Maquina electrosoldable universal

Universal electrofusion welding machine
Machine à souder universel

COLLARINES

CLAMP SADDLES

COLLIERS DE PRISE EN CHARGE

CARACTERISTICAS CHARACTERISTICS CARACTERISTIQUES	CODIGO CODE CODE	Ø TUBO Ø PIPE Ø TUBE	SALIDA OUT SORTIE	Nº TORNILLOS Nº SCREWS Nº BOULONS	U/CAJA U/BOX U/CAISSES
	7CL2520	25	1/2"	2	150
	7CL2525	25	3/4"	2	150
	7CL3220	32	1/2"	2	150
	7CL3225	32	3/4"	2	150
	7CL3232	32	1"	2	150
	7CL4020	40	1/2"	2	100
	7CL4025	40	3/4"	2	100
	7CL4032	40	1"	2	100
	7CL5020	50	1/2"	2	100
	7CL5025	50	3/4"	2	100
	7CL5032	50	1"	2	100
	7CL5040	50	1 1/4"	2	100
	7CL6320	63	1/2"	4	80
	7CL6325	63	3/4"	4	80
	7CL6332	63	1"	4	80
	7CL6340	63	1 1/4"	4	80
	7CL6350	63	1 1/2"	4	80
	7CL7520	75	1/2"	4	40
	7CL7525	75	3/4"	4	40
	7CL7532	75	1"	4	40
	7CL7540	75	1 1/4"	4	40
	7CL7550	75	1 1/2"	4	40
	7CL7563	75	2"	4	40
	7CL9020	90	1/2"	4	34
	7CL9025	90	3/4"	4	34
	7CL9032	90	1"	4	34
	7CL9040	90	1 1/4"	4	34
	7CL9050	90	1 1/2"	4	34
	7CL9063	90	2"	4	34
	7CL11020	110	1/2"	4	20
	7CL11025	110	3/4"	4	20
	7CL11032	110	1"	4	20
	7CL11040	110	1 1/4"	4	20
	7CL11050	110	1 1/2"	4	20
	7CL11063	110	2"	4	20
	7CL12520	125	1/2"	4	20
	7CL12525	125	3/4"	4	20
	7CL12532	125	1"	4	20
	7CL12540	125	1 1/4"	4	20
	7CL12550	125	1 1/2"	4	20
	7CL12563	125	2"	4	20
	7CL14020	140	1/2"	4	20
	7CL14025	140	3/4"	4	20
	7CL14032	140	1"	4	20
	7CL14040	140	1 1/4"	4	20
	7CL14050	140	1 1/2"	4	20
	7CL14063	140	2"	4	20
	7CL16020	160	1/2"	4	20
	7CL16025	160	3/4"	4	20
	7CL16032	160	1"	4	20
	7CL16040	160	1 1/4"	4	20
	7CL16050	160	1 1/2"	4	20
	7CL16063	160	2"	4	20

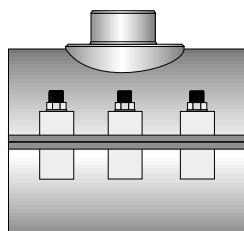
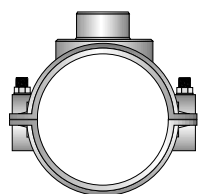

Materiales Materials Materials

1.- Cuerpo en PP.

1.- Build in PP.

1.- Collier a PP.

2.- Junta tórica en NBR.

2.- O-ring in NBR

2.- Joint torique a NBR

3.- Tornillería metálica zincada.

3.- Screw zinc metal

3.- Boulons acier zinqué