

TOGGLE PRESSES

Manual toggle presses with square ram VK series / L-VK series

The square ram has significant advantages over the round ram:

- absolute torsion resistance
- hardened, precisely ground ram
- play-free movement of the press ram
- adjustable jib strips of the square ram
- large support surface for the tool
- guides on the tool are therefore usually unnecessary
- virtually maintenance-free operation

Additional standard equipment:

- height adjustment of the press head using a threaded spindle
- side-located measuring strip for repeatably accurate setting of press head

These models can also be fitted with the usual extras:

- Precision ram adjustment for precise setting of the insertion depth (DP)
- Return travel lock for quality assurance during production (HS)
- Stroke counter (Z)
- Central table bore (TB)

mänder manual toggle presses with square rams are ideal tools for the production of high-precision small components with narrow tolerances in small and medium batches, where automation would be uneconomical.



VK 750-40

L-VK 750-40

Type		VK 500-40	VK 750-40	L -VK 750-40
Capacity	kN	5.0	7.5	7.5
	kp	500	750	750
Working stroke		mm	40	40
Throat	A	mm	63	80
	B	mm	45 - 220	48 - 208
Daylight	B	mm	30 - 205	32 - 192
Table size	C x D	mm	100 x 65	155 x 115
T-slot width similar to DIN 650		mm	10	12
Ram bore Ø x depth	E	mm	10 ^{H7} x 25	10 ^{H7} x 25
Ram cross-section	H	mm	21 x 21	25 x 25
Space requirement	C x G	mm	110 x 160	155 x 220
Weight	kg	approx. 10	approx. 20	approx. 28

Extras (see Page 3)		Please indicate with order		
Precision ram adjustment	DP	DP	DP	DP
Return travel lock	HS	HS	HS	HS
Stroke counter	Z	Z	Z	Z
Table bore 12 ^{H7}	TB	TB	TB	TB

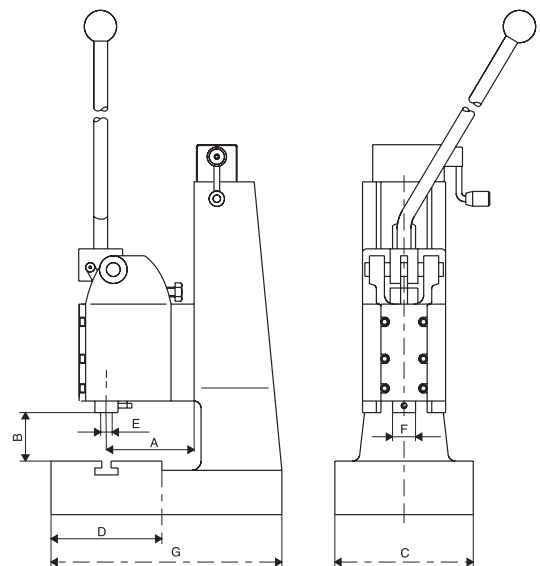

TOGGLE PRESSES

Manual toggle presses with square ram
VK series / XL-VK series / PHK series



VK 1500-40



PHK 600

The proven PHK 600 rounds off the mäder range of toggle presses with square rams.

Type			VK 1500-40	VK 1500-60	VK 2500-40	VK 2500-60	XLVK 1500-40	XLVK 1500-60	PHK 600-08
Capacity		kN	15.0	15.0	25.0	25.0	15.0	15.0	6.0
		kp	1500	1500	2500	2500	1500	1500	600
Working stroke		mm	40	60	40	60	40	60	25
Throat	A	mm	100	100	100	100	250	250	85
Daylight	B	mm	43 - 164	43 - 170	57 - 238	52 - 245	90 - 176	91 - 183	60 - 140
Daylight with DP	B	mm	32 - 153	26 - 153	46 - 227	35 - 228	79 - 165	74 - 166	-
Table size	C x D	mm	175 x 140	175 x 140	185 x 145	185 x 145	200 x 200	200 x 200	160 x 100
T-slot width DIN 650		mm	12	12	12	12	12	12	ø 10,5
Ram bore Ø x depth	E	mm	10 ^{H7} x 30	10 ^{H7} x 30	10 ^{H7} x 30	10 ^{H7} x 30	10 ^{H7} x 30	10 ^{H7} x 30	8H6 x 25*
Ram cross-section		H	31 x 31	31 x 31	31 x 31	31 x 31	31 x 31	31 x 31	25 x 35
Fixing holes		6 x	-	-	-	-	-	-	-
Space requirement		C x G	175 x 300	175 x 300	185 x 300	185 x 300	200 x 450	200 x 450	160 x 220
Weight		kg	approx. 39	approx. 43	approx. 41	approx. 46	approx. 55	approx. 59	approx. 18

Extras (see Page 3)					Please indicate with order		
Precision ram adjustment	DP	DP	DP	DP	DP	DP	-
Return travel lock	HS	HS	HS	HS	HS	HS	HS
Stroke counter	Z	Z	Z	Z	Z	Z	Z
Table bore 12 ^{H7}	TB	TB	TB	TB	TB	TB	Standard

* Other ram bores on request