

TRINA TSM-P03 165W to 185W Photovoltaic Solar Module

STRENGTHS

- Tolerance $\pm 3\%$
- High Transmission: Low Iron Tempered Glass
- 6 Bypass Diode Integrated
- Plug & Play Connectors

WARRANTY

- Product: 2 years
- Production: 90%-----10 years
80%-----25 years

CERTIFICATIONS



High Efficiency Multicrystalline Solar Modules

TYPICAL ELECTRICAL CHARACTERISTICS

Typical Type	P03	TSM-165	TSM-170	TSM-175	TSM-180	TSM-185
Max-Power	Pm(W)	165	170	175	180	185
Power Tolerance	(%)	± 3	± 3	± 3	± 3	± 3
Max-Power Voltage	Vm(V)	23.8	24.0	24.2	24.4	24.7
Max-Power Current	Im(A)	6.95	7.10	7.25	7.38	7.50
Open-Circuit Voltage	Voc(V)	29.0	29.2	29.4	29.6	29.8
Short-Circuit Current	Isc(A)	7.60	7.72	7.82	7.95	8.08
Max-System Voltage	(VDC)	1000				
Cell Efficiency	$\eta_c(\%)$	14.1	14.6	15.0	15.4	15.8
Module Efficiency	$\eta_m(\%)$	12.6	13.0	13.4	13.8	14.2
Type, Number and Array of Cells		Multi-crystalline Silicon, 48 in series (6x8)				
Cell Size	(mm)	156 X 156				
Cable type, Diameter and Length		4mm ² , TÜV Certified, 1000mm				
Type of Connector		Compatible with Type III or Type IV				
No. of Bypass Diodes		6 pcs (2 in parrallel)				
Max. Series Fuse	(A)	11				
Pm Temperature Coefficient	(%/°C)	- 0.45				
Isc Temperature Coefficient	(%/°C)	0.05				
Voc Temperature Coefficient	(%/°C)	- 0.35				
Nom. Operating Temp. of Cells	(°C)	47 \pm 2				

MECHANICAL CHARACTERISTICS

Dimension	A*B*C	(mm)	1316*992*40
Weight		(Kg)	15.5
No. of Draining Holes In Frame			8 pcs
Front Glass, Type and Thickness			High Transmiss., Low Iron, Tempered Glass 3.2mm.
Packing Configuration			2 in 1 or 23 in 1
Quantity/Pallet			38 pcs/pallet or 24pcs/pallet
Loading Capacity			608 pcs/40ft or 736pcs/40ft(H)

ABSOLUTE RATINGS

Dielectric Insulation Voltage	(VDC)	3000 max.
Operating Temperature	(°C)	-40~+85
Storage Temperature	(°C)	-40~+85

*STC Conditions(1000W/m²; 1.5 AM and 25°C Cell temperature)



TRINA TSM- P03 165W to 185W

Photovoltaic Solar Module

I-V Curves

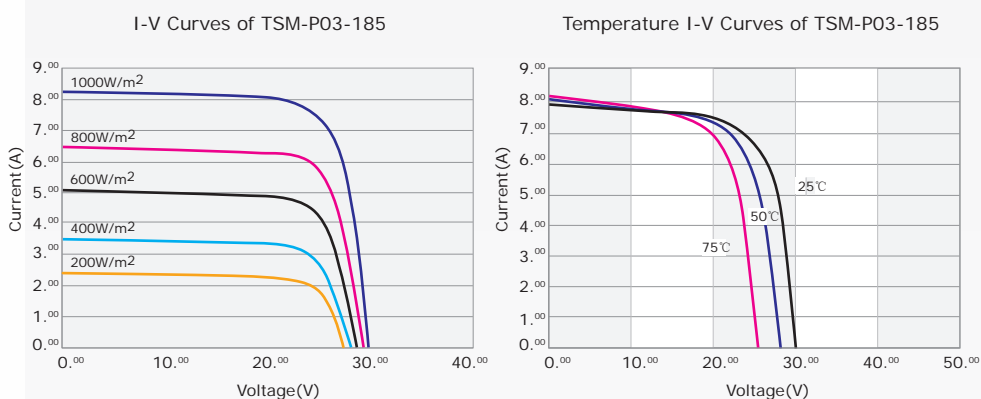

Dimensions

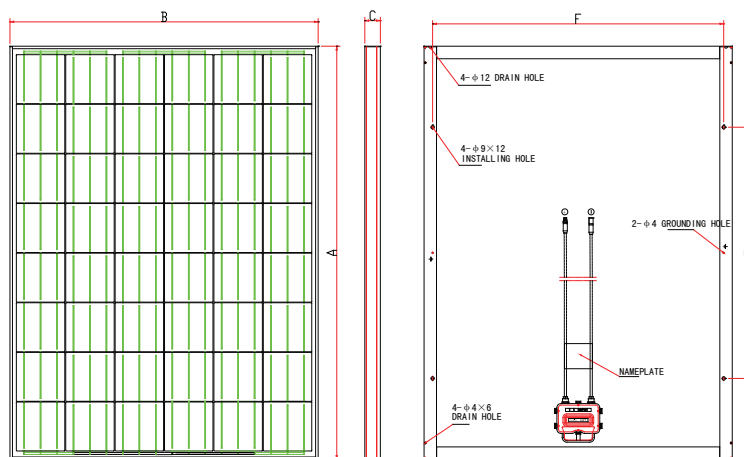

Dimensions (mm)	A*B*C	1316*992*40
Installation Hole (mm)	E*F	990*941
Cable Length(mm)	G	1000
Cable diameter (mm)		Φ9×12
Test Conditions		STC:AM=1.5, 1000W/m ² , Cells Temperature 25°C

