



Paul Löbe Haus, Berlin

## GEZE TZ 210 (N), TE 210 Set

GEZE SecuLogic Emergency Exit Systems

## Single door control unit GEZE TZ 210 (N)

If it concerns the safety of an escape door to small costs and with a minimum requirements, the TZ 210 (N) is the right choice. It has all necessary capability characteristics around an individual self-sufficient escape door with appropriate locking devices to supervise.

Compact control electronics as well as local control elements and the power-pack can be installed into standard flush-mounted technology without any problems

– set off controls and power-packs belong to the past.

Three LED`s announce the current state of system, position of door leaf as well as lining up alarms.

The TZ 210 (N) more-over provides input for the danger alarm system e.g. fire alarm system, an access control system and a timer. External alarm indicators such as flashing light or siren can be connected via a potential-free contact.

The attitude of the door parameters such as f.ex. duration for short-time release, early warning, alarm etc. is done by the integrated key operated switch, without the need at further aids.

Surface-mounted (AP) and flush-mounted (UP) versions of the single door control unit TZ 210 (N) are available.

Both versions are available with (TZ 210 N) resp. without (TZ 210) integrated power-pack.



TZ 210 (N) flush-mounted, Gira E 2 pure white



TZ 210 (N) surface-mounted, stainless steel



TZ 210 (N) surface-mounted, green (RAL 6032)

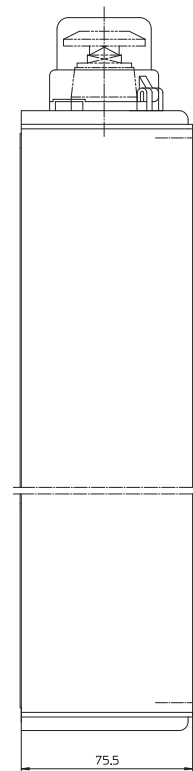
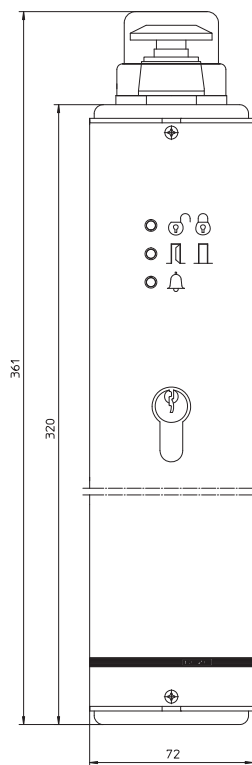
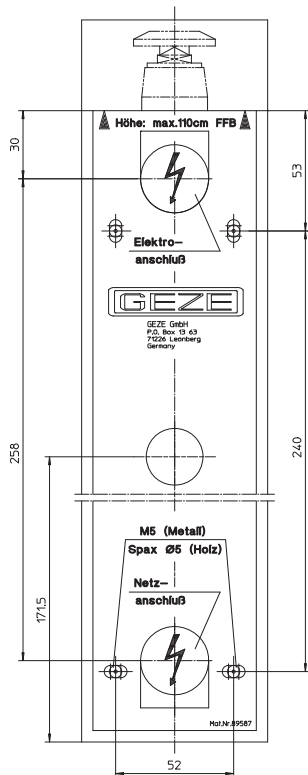
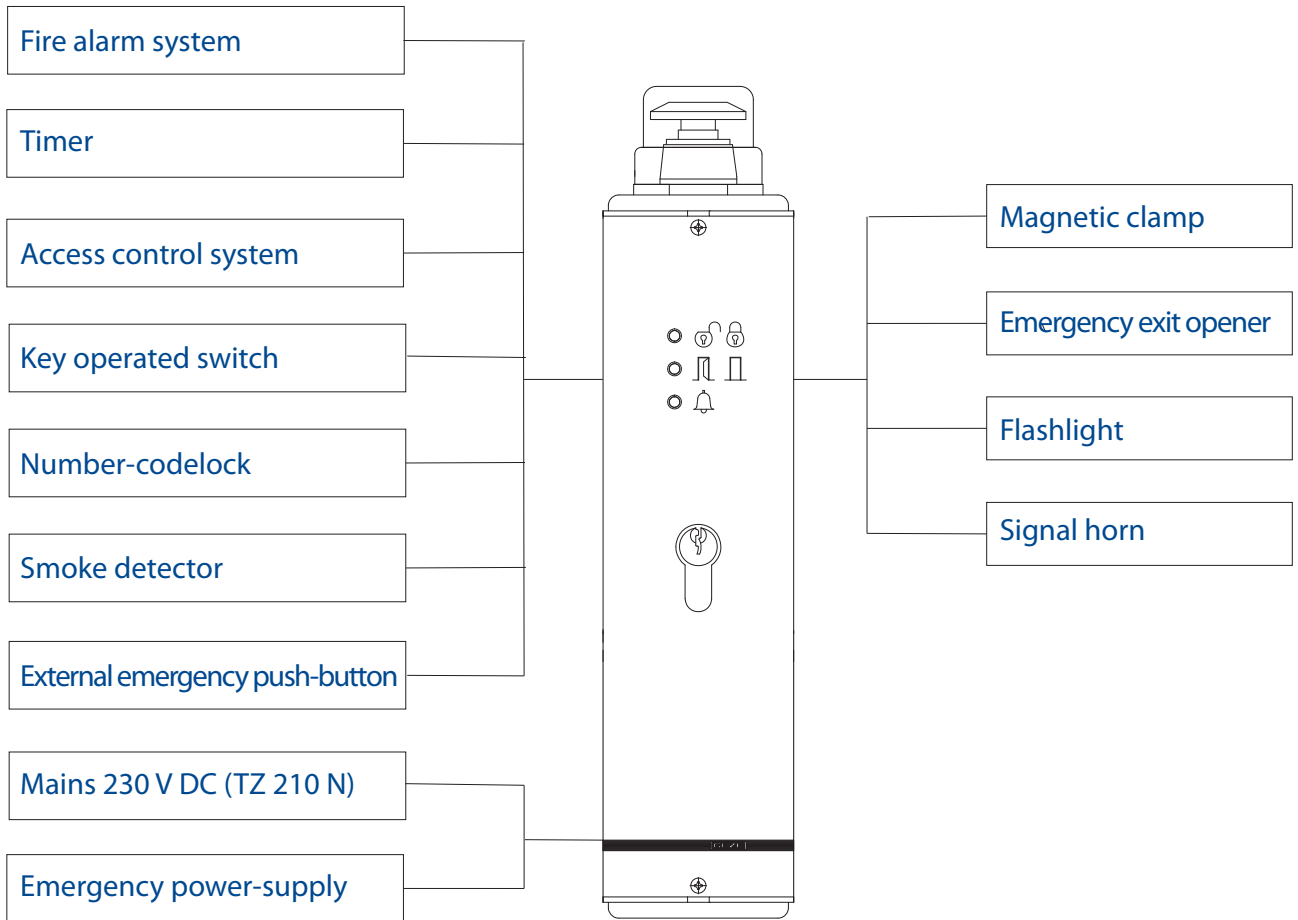

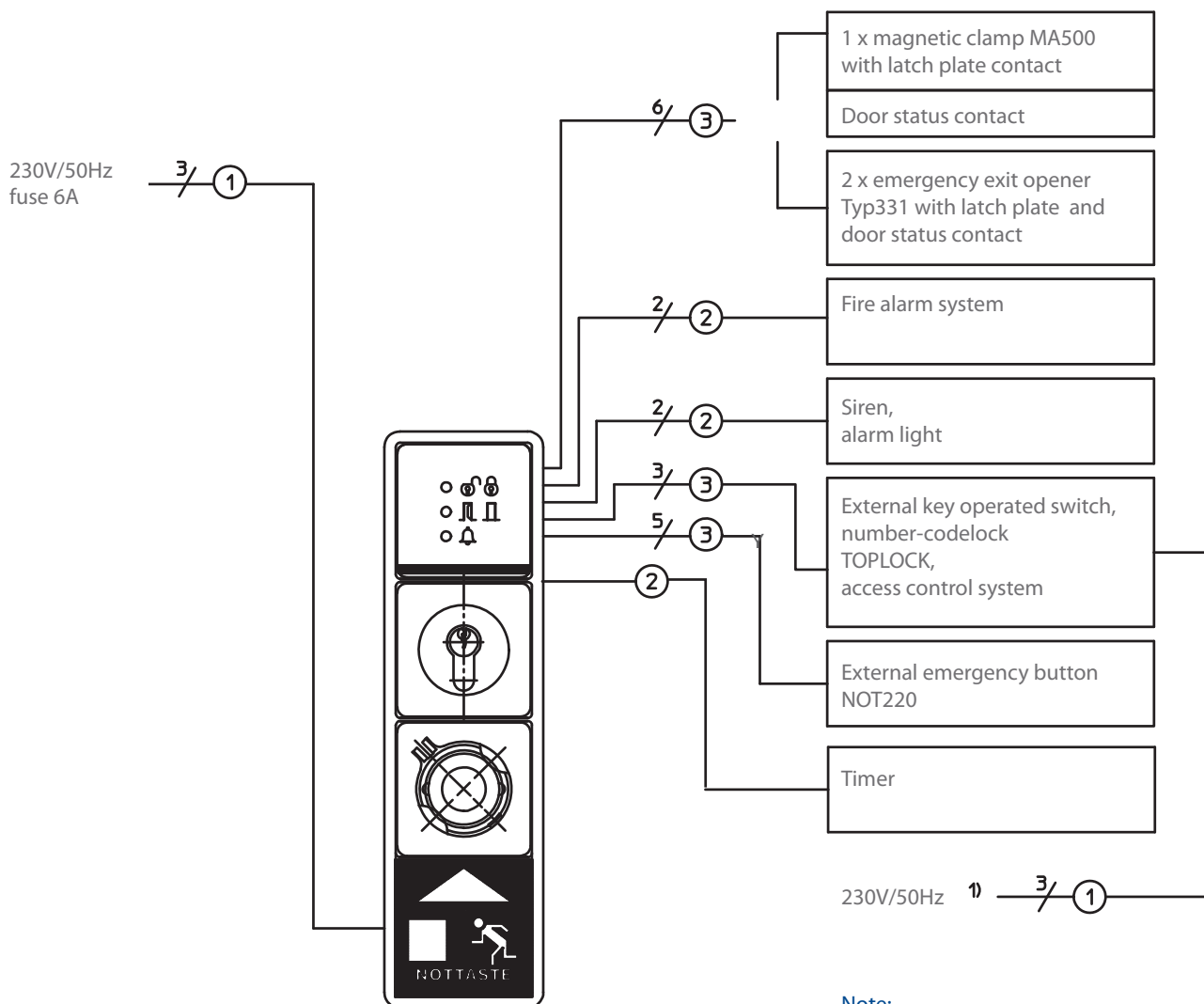

Fig. 04-1 · Cable diagram ((Drawing No. 35201-9-0952)

**Note:**

1) only with variants with separate evaluation unit (CTS, CTS V, CTS B, CTS BV)

All lines in accordance with VDE 0815

- ① NYM-J 3x1,5mm<sup>2</sup>
- ② J-Y (ST) Y 2x2x0,8
- ③ J-Y (ST) Y 4x2x0,8

**Mounting information:**

- ▶ Mounting height of emergency push-button: 850 mm -1200 mm
- ▶ Install door control unit and door terminal in direct proximity of the door
- ▶ Install the emergency push-button always together with the escape route sign. The arrow points to the emergency push-button.
- ▶ Passage height under the magnetic clamp greater than 2000 mm
- ▶ Attach manufacturer-certified components only
- ▶ Mains connection only by electrical specialist
- ▶ Shift lines sabotage-secured according to VDE0833, Surface-mounted lines in metal tube or in plastic troughing with metal spiral protecting cover

Technical data	
3 LED displays for the door conditions	<ul style="list-style-type: none"> <li>▶ locked, unlocked</li> <li>▶ door leaf open, closed</li> <li>▶ alarm, early warning</li> </ul>
Integrated, lit up emergency push-button	
Integrated key operated switch for	<ul style="list-style-type: none"> <li>▶ unlocking, short-time unblocking</li> <li>▶ locking</li> <li>▶ reset alarm</li> <li>▶ setting of short-term release, early warning and acoustic alarm duration, buzzer on/off, run-after on/off</li> </ul>
Integrated, differentiated acoustic alarm to announce early warning or using of the emergency push-button	
Integrated security function against sabotage	
Automatic abort of short-time unblocking with closing the door	
Hunting time of the short-time unblocking selectable	
Automatic storage and activation of the operating conditions before and after power failure	
TZ 210 N with integrated power-pack	

### Connections

- ▶ Input for emergency unlocking via a fire alarm system or similar devices
- ▶ Input for access control system and timer
- ▶ Potential-free output (changeover device) for optical/acoustical announcement or display of common alarm (except early warning)
- ▶ Connecting possibilities for locking devices
- ▶ Enclosure rating IP 30
- ▶ Mains voltage 230 V AV, 50 Hz with TZ 210 N
- ▶ Operating voltage 24 V DC
- ▶ Power input 100 mA
- ▶ Current consumption
  - with TZ 210 N flush-mounted (UP) 400 mA,
  - with TZ 210 N surface-mounted (AP) 700 mA

### Dimensions

- ▶ Surface-mounted (AP) (HxWxD) 361 x 72 x 75,5 mm
- ▶ Flush-mounted (UP) (HxWxD) 295 x 81 mm for mounting of 4 pcs concealed casing with depth 62,5 mm

# GEZE TE 210 Set

The TE 210 Set completes the door control unit TZ 210 and makes it an easy to fit multi-door system with attractive optical appearance, modern bus technology and a remarkable price-performance ratio.

This combination offers the possibility to secure and control a total of 7 escape doors from a central board. A central network supplies the components with voltage and supersedes separate mains cables for door control unit and control panels.

The attractive control panel allows the operation of the functions locking, unlocking and short-term unlocking. 3 LED's display the door modes "locked/unlocked", "door open/closed" as well as alarm.

The signal transfer between the control panel and the door control unit is based on modern two-wire bus technology and thus reduces the expenditure for wiring and electric connection to a minimum.

Commissioning of the bus system is made at the bus distributor RC 210 via plug & play without the necessity of setting addresses and without any further auxiliaries or programming devices.

The scope of delivery of the TE 210 Set includes the control panel TE 210, the bus distributor RC 210 and the power pack NET 24-5.

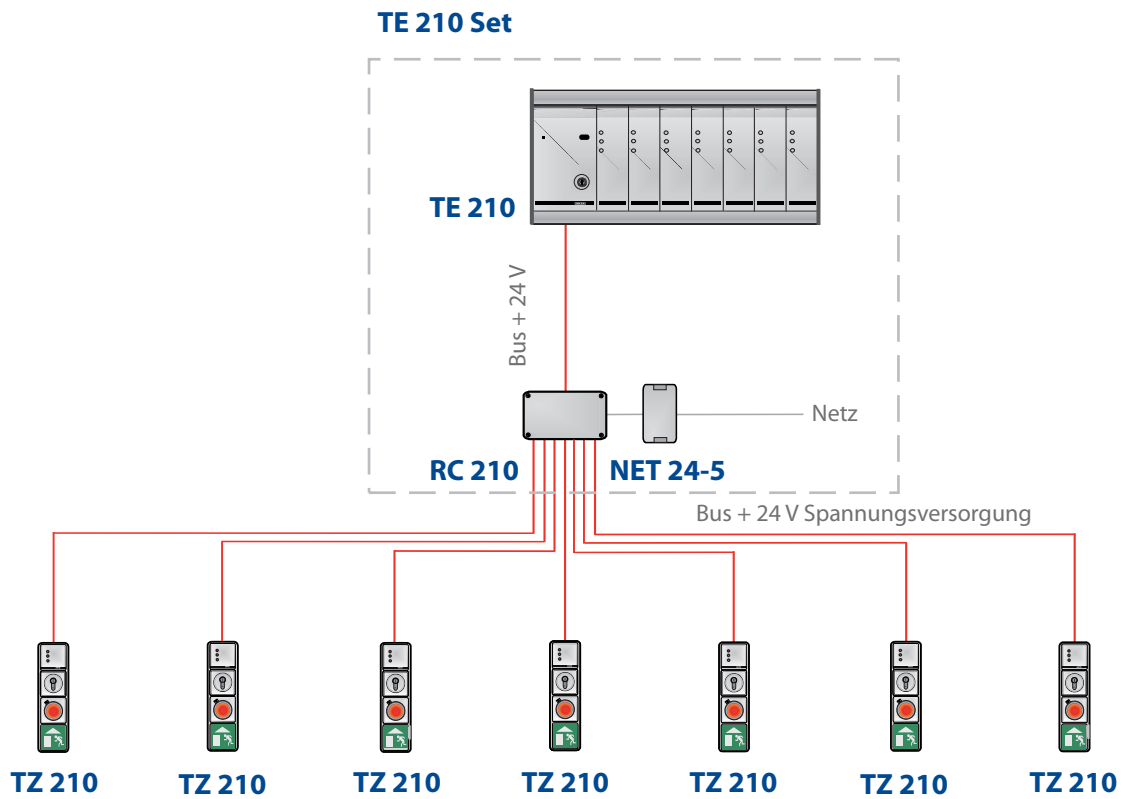

## GEZE TE 210 Set – System components

Control panel TE 210



Tableaueinheit TE 210



- ▶ Flat, attractive design
- ▶ Removable/extendible up to 7 doors
- ▶ LED display for "door locked/unlocked", "door open/closed" alarm
- ▶ Operation of locking/unlocking/short-term unlocking per door
- ▶ Locking of the control panel via key-operated switch
- ▶ Potential-free alarm output for collective alarm of all doors
- ▶ Type of enclosure IP 20
- ▶ Dimensions HxWxD: 160 x 319 x 22 mm

Bus distributor RC 210



Power pack NET 24-5



- ▶ Connections for 7 door control units TZ 210, 1 control panel TE 210 and central voltage supply
- ▶ Operating voltage 24 V DC
- ▶ Type of enclosure IP 54
- ▶ Dimensions (HxWxD): 135 x 170 x 90 mm

- ▶ Suited for fitting to top-hat rail
- ▶ Input voltage 230 V AC
- ▶ Output voltage 26 V DC
- ▶ Output current 5 A
- ▶ Type of enclosure IP 20
- ▶ Dimensions (HxWxD): 125,5 x 65,5 x 100 mm

**GEZE GmbH**

**P.O. Box 1363**  
**71226 Leonberg**  
**Germany**

GEZE GmbH  
 Reinhold-Vöster-Straße 21-29  
 71229 Leonberg  
 Germany  
 Telefon +49 (0) 7152-203-0  
 Telefax +49 (0) 7152-203-310

**www.geze.com**

**Germany**

GEZE Sonderkonstruktionen GmbH  
 Planken 1  
 97944 Boxberg-Schweigern  
 Tel. +49 (0) 7930-9294-0  
 Fax +49 (0) 7930-9294-10  
 E-Mail: sk.de@geze.com

**Germany**

GEZE GmbH  
 Niederlassung Nord/Ost  
 Böhrlingstraße 8  
 13086 Berlin (Weissensee)  
 Tel. +49 (0) 30-47 89 90-0  
 Fax +49 (0) 30-47 89 90-17  
 E-Mail: berlin.de@geze.com

**Germany**

GEZE GmbH  
 Niederlassung West  
 Nordsternstraße 65  
 45329 Essen  
 Tel. +49 (0) 201-83082-0  
 Fax +49 (0) 201-83082-20  
 E-Mail: essen.de@geze.com

**Germany**

GEZE GmbH  
 Niederlassung Mitte  
 Adenauerallee 2  
 61440 Oberursel (b. Frankfurt)  
 Tel. +49 (0) 6171-63610-0  
 Fax +49 (0) 6171-63610-1  
 E-Mail: frankfurt.de@geze.com

**Germany**

GEZE GmbH  
 Niederlassung Süd  
 Reinhold-Vöster-Straße 21-29  
 71229 Leonberg  
 Tel. +49 (0) 7152-203-594  
 Fax +49 (0) 7152-203-438  
 E-Mail: leonberg.de@geze.com

**Germany**

GEZE Service GmbH  
 Reinhold-Vöster-Straße 25  
 71229 Leonberg  
 Tel. +49 (0) 7152-9233-0  
 Fax +49 (0) 7152-9233-60  
 E-Mail: info@geze-service.com

**Germany**

GEZE Service GmbH  
 Niederlassung Berlin  
 Böhrlingstraße 8  
 13086 Berlin (Weissensee)  
 Tel. +49 (0) 30-470217-30  
 Fax +49 (0) 30-470217-33

**Austria**

GEZE Austria GmbH  
 Mayrwiesstraße 12  
 5300 Hallwang b. Salzburg  
 Tel. +43-(0)662-663142  
 Fax +43-(0)662-663142-15  
 E-Mail: austria.at@geze.com

**Baltic States**

GEZE GmbH Baltic States office  
 Dzelzavas iela 120 S  
 1021 Riga  
 Tel. +371 (0) 67 89 60 35  
 Fax +371 (0) 67 89 60 36  
 E-Mail: office-latvia@geze.com

**Benelux**

GEZE Benelux B.V.  
 Leemkuil 1  
 Industrierterrein Kapelbeemd  
 5626 EA Eindhoven  
 Tel. +31-(0)40-26290-80  
 Fax +31-(0)40-26 290-85  
 E-Mail: benelux.nl@geze.com

**Bulgaria**

GEZE Bulgaria - Trade  
 Representative Office  
 61 Pirinski Prohod, entrance „B“,  
 4th floor, office 5,  
 1680 Sofia  
 Tel. +359 (0) 24 70 43 73  
 Fax +359 (0) 24 70 62 62  
 E-Mail: office-bulgaria@geze.com

**China**

GEZE Industries (Tianjin) Co., Ltd.  
 Shuangchenzhong Road  
 Beichen Economic Development  
 Area (BEDA)  
 Tianjin 300400, P.R. China  
 Tel. +86(0)22-26973995-0  
 Fax +86(0)22-26972702  
 E-Mail: Sales-info@geze.com.cn

**China**

GEZE Industries (Tianjin) Co., Ltd.  
 Branch Office Shanghai  
 Unit 25N, Cross Region Plaza  
 No 899, Ling Ling Road,  
 XuHui District  
 200030 Shanghai, P.R. China  
 Tel. +86 (0)21-523 40 960  
 Fax +86 (0)21-644 72 007  
 E-Mail: gezesh@geze.com.cn

**China**

GEZE Industries (Tianjin) Co., Ltd.  
 Branch Office Guangzhou  
 Room 17C3  
 Everbright Bank Building, No.689  
 Tian He Bei Road  
 510630 Guangzhou  
 P.R. China  
 Tel. +86(0)20-38731842  
 Fax +86(0)20-38731834  
 E-Mail: gezegz@geze.com.cn

**China**

GEZE Industries (Tianjin) Co., Ltd.  
 Branch Office Beijing No. 6-32  
 Building  
 Jili Avenue  
 Daxing District  
 100076 Beijing, P.R. China  
 Tel. +86-(0)10-879751-77/-78  
 Fax +86-(0)10-879751-71  
 E-Mail: gezebj@geze.com.cn

**France**

GEZE France S.A.R.L.  
 ZAC de l'Orme Rond  
 RN 19  
 77170 Servon  
 Tel. +33-(0)1-606260-70  
 Fax +33-(0)1-606260-71  
 E-Mail: france.fr@geze.com

**Hungary**

GEZE Hungary Kft.  
 Bartók Béla út 105-113.  
 Budapest  
 H-1115  
 Tel. +36 (1) 481 4670  
 Fax +36 (1) 481 4671  
 E-Mail: office-hungary@geze.com

**Iberia**

GEZE Iberia S.R.L.  
 Pol. Ind. El Pla  
 C/Comerc, 2-22, Nave 12  
 08980 Sant Feliu de Llobregat  
 (Barcelona)  
 Tel. +34(0)9-02194036  
 Fax +34(0)9-02194035  
 E-Mail: info@geze.es

**India**

GEZE GmbH India Liaison Office  
 409, Apeejay Business Centre  
 39, Haddows Road  
 Chennai - 600 006  
 Tamil Nadu  
 Tel. +91 (0) 44 28 21 13 00  
 Fax +91 (0) 44 28 21 13 00  
 Mobile +91 (0) 9 962 592 636  
 E-Mail: office-india@geze.com

**Italy**

GEZE Italia Srl  
 Via Giotto, 4  
 20040 Cambiago (MI)  
 Tel. +3902950695-11  
 Fax +3902950695-33  
 E-Mail: italia.it@geze.com

**Italy**

GEZE Engineering Roma Srl  
 Via Lucrezia Romana, 91  
 00178 Roma  
 Tel. +3906-7265311  
 Fax +3906-72653136  
 E-Mail: roma@geze.biz

**Kazakhstan**

GEZE Central Asia  
 050061, Almaty, Kazakhstan  
 Rayimbek ave. 348, A, office 310  
 Tel. +7 (0) 72 72 44 78 03  
 Fax +7 (0) 72 72 44 78 03  
 E-Mail: office-kazakhstan@geze.com

**Poland**

GEZE Polska Sp.z o.o.  
 ul. Annopol 21  
 03-236 Warszawa  
 Tel. +48 (0)22 440 4 440  
 Fax +48 (0)22 440 4 400  
 E-Mail: geze.pl@geze.com

**Romania**

GEZE GmbH Reprezentanta Romania  
 Str. Ionescu Baican nr. 22  
 RO-021835 Bucuresti, sector 2  
 Tel. +40 (0) 21 25 07 750  
 Fax +40 (0) 21 25 07 750  
 E-Mail: office-romania@geze.com

**Russian Federation**

GEZE GmbH Representative  
 Office Russia  
 Kolodesnij pereulok3, str. 25  
 Office Nr. 5201-5203  
 107076 Moskau  
 Tel. +7 (0) 49 55 89 90 52  
 Fax +7 (0) 49 55 89 90 51  
 E-Mail: office-russia@geze.com

**Scandinavia**

GEZE Scandinavia AB  
 Mallslödingen 10  
 Box 7060  
 18711 Täby, Sweden  
 Tel. +46(0)8-7323-400  
 Fax +46(0)8-7323-499  
 E-Mail: sverige.se@geze.com

**Scandinavia**

GEZE Norway  
 Industriveien 34 B  
 2073 Dal  
 Tel. +47(0)639-57200  
 Fax +47(0)639-57173  
 E-Mail: norge.se@geze.com

**Scandinavia**

GEZE Finland  
 Postbox 20  
 15871 Hollola  
 Tel. +358(0)10-4005100  
 Fax +358(0)10-4005120  
 E-Mail: finland.se@geze.com

**Scandinavia**

GEZE Denmark  
 Høje Taastrup Boulevard 53  
 2630 Taastrup  
 Tel. +45(0)46-323324  
 Fax +45(0)46-323326  
 E-Mail: danmark.se@geze.com

**South Africa**

DCLSA Distributors (Pty.) Ltd.  
 1027 Richards Drive, Midrand  
 P.O. Box 7934  
 Midrand 1685  
 Tel. +27(0)113158286  
 Fax +27(0)113158261  
 E-Mail: info@dclsa.co.za

**Switzerland**

GEZE Schweiz AG  
 Bodenackerstrasse 79  
 4657 Dulliken  
 Tel. +41-(0)62-2855400  
 Fax +41-(0)62-2855401  
 E-Mail: schweiz.ch@geze.com

**Turkey**

GEZE GmbH Türkiye - İstanbul  
 İrtibat Bürosu  
 Ataşehir Bulvarı, Ata 2/3  
 Plaza Kat: 9 D: 84 Ataşehir  
 Kadıköy / İstanbul  
 Tel. +90 (0) 21 64 55 43 15  
 Fax +90 (0) 21 64 55 82 15  
 E-Mail: office-turkey@geze.com

**Ukraine**

Repräsentanz GEZE GmbH Ukraine  
 ul. Vikentiya Hvoyki, 21,  
 office 151  
 04080 Kiev  
 Tel. +38 (0) 44 49 97 725  
 Fax +38 (0) 44 49 97 725  
 E-Mail: office-ukraine@geze.com

**United Arab Emirates/GCC**

GEZE Middle East  
 P.O. Box 17903  
 Jebel Ali Free Zone  
 Dubai  
 Tel. +971(0)4-8833112  
 Fax +971(0)4-8833240  
 E-Mail: geze@emirates.net.ae

**United Kingdom**

GEZE UK Ltd.  
 Blenheim Way  
 Fradley Park  
 Lichfield  
 Staffordshire WS13 8SY  
 Tel. +44(0)1543443000  
 Fax +44(0)1543443001  
 E-Mail: info.uk@geze.com

**GEZE Representative**